

# Linear Waterbody Data Sheet

Survey Description			
Project Name: Atlantic Coast Pipeline		Waterbody Name: UNT to Appomattox River	
Waterbody ID: spea400		Date: 2/20/2016	
State: Virginia	County: Prince Edward	Company: NRG	Crew Member Initials: GB, SA
Photos: 3 Photos			
Tract Number(s): 11-001		Nearest Milepost: 220.8	Associated Wetland ID(s): Originates as outflow from PEM wetland outside corridor
Survey Type: <i>(check one)</i> <input type="checkbox"/> Centerline <input checked="" type="checkbox"/> Re-Route <input type="checkbox"/> Access Road <input type="checkbox"/> Other:			
Physical Attributes			
Stream Classification: <i>(check one)</i> <input type="checkbox"/> Ephemeral <input checked="" type="checkbox"/> Intermittent <input type="checkbox"/> Perennial			
Waterbody Type: <i>(check one)</i> <input type="checkbox"/> River <input checked="" type="checkbox"/> Stream <input type="checkbox"/> Ditch <input type="checkbox"/> Canal <input type="checkbox"/> Other:			
OHWM Width: 3.0 ft.		OHWM Indicator: <i>(check all that apply)</i> <input checked="" type="checkbox"/> Clear line on bank <input type="checkbox"/> Shelving <input type="checkbox"/> Wrested vegetation <input checked="" type="checkbox"/> Scouring <input type="checkbox"/> Water staining	
OHWM Height: 1.0 ft.		<input checked="" type="checkbox"/> Bent, matted, or missing vegetation <input type="checkbox"/> Wrack line <input type="checkbox"/> Litter and debris <input type="checkbox"/> Abrupt plant community change <input type="checkbox"/> Soil characteristic change	
N/A <input type="checkbox"/>			
Width of Waterbody - Top of Bank to Top of Bank: 5.0 ft.	Width of Waterbody - Toe of Slope to Toe of Slope: 2.0 ft.	Width of Waterbody - Water Edge to Water Edge: 3.0 ft.	Depth of Water: <i>(Approx.)</i> 0.25 ft.
N/A <input type="checkbox"/>		N/A <input type="checkbox"/>	
Sinuosity: <i>(check one)</i> <input type="checkbox"/> Straight <input checked="" type="checkbox"/> Meandering		Water velocity: <i>(Approx.)</i> 0.20 fps	Bank height: Right: 3.0 ft. Left: 3.0 ft.
N/A <input type="checkbox"/>		Bank slope: Right: 80 degrees Left: 80 degrees	
Qualitative Attributes			
Water Appearance: <i>(check one)</i> <input type="checkbox"/> No water <input checked="" type="checkbox"/> Clear <input type="checkbox"/> Turbid <input type="checkbox"/> Sheen on surface <input type="checkbox"/> Surface scum <input type="checkbox"/> Algal mats <input type="checkbox"/> Other:			
Substrate: <i>(check all that apply)</i> <input type="checkbox"/> Bedrock <input type="checkbox"/> Boulder <input type="checkbox"/> Cobble <input type="checkbox"/> Gravel <input checked="" type="checkbox"/> Sand <input checked="" type="checkbox"/> Silt/ clay <input checked="" type="checkbox"/> Organic <input type="checkbox"/> Other:			
% of Substrate:      _____%      _____%      _____%      _____%      40%      50%      10%      _____%			
Width of Riparian Zone: On floodplain of Appomattox River		Vegetative Layers: <i>(check all that apply)</i> <input checked="" type="checkbox"/> Trees: <input checked="" type="checkbox"/> Saplings/Shrubs: <input checked="" type="checkbox"/> Herbs	
Avg. DBH of Dominants: <i>(approx.)</i> 9.0 in.		1.0 in.	
Dominant Bank Vegetation <i>(list)</i> : White oak, red elm, green ash, red maple, ironwood, multiflora rose, Japanese honeysuckle, river oats, rough sedge, smilax, panic grass, wingstem			
Aquatic Habitats (ex: submerged or emerged aquatic vegetation, overhanging banks/roots, leaf packs, large submerged wood, riffles, deep pools): Leaf packs			
Aquatic Organisms Observed <i>(list)</i> : none			
T&E Species Observed <i>(list)</i> : none			
Disturbances (ex: livestock access, manure in waterbody, waste discharge pipes): Historic livestock access now fenced for exclusion in part; active livestock access upstream			
Tributary is: <i>(check one)</i> <input checked="" type="checkbox"/> Natural <input type="checkbox"/> Artificial, man-made <input type="checkbox"/> Manipulated			
Stream Quality <sup>3</sup> : <i>(check one)</i> <input type="checkbox"/> High <input type="checkbox"/> Moderate <input checked="" type="checkbox"/> Low			

Waterbody ID:  
spea400

<sup>a</sup> **High Quality:** Natural channel, natural vegetation extends at least one or two active channel widths on each side; banks stable and protected by roots; water color is clear to tea-colored; no barriers to fish movement; many fish cover types available; diverse and stable aquatic habitat; no disturbance by livestock or man.

**Moderate Quality:** Altered channel evidenced by rip-rap; natural vegetation extends 1/3-1/2 of the active channel width on each side; filtering function or riparian vegetation only moderately compromised; banks moderately unstable; water color is cloudy, submerged objects covered with greenish film; moderate odor; minor barriers to fish movement; fair aquatic habitat; minimum disturbance by livestock or man.

**Low Quality:** Channel is actively down cutting or widening; rip rap and channelization excessive; natural vegetation less than 1/3 of the active channel width on each side; lack of regeneration; filtering function severely compromised; banks unstable (eroding); water color is muddy and turbid; obvious pollutants (algal mats, surface scum, surface sheen); heavy odor; severe barriers to fish movement; little to no aquatic habitat; severe disturbance from livestock or man.

**Notes:**

Stream begins within PEM wetland in an active livestock pasture outside of corridor; downstream flows into Appomattox River at edge of survey corridor. Loses bed and bank in segments where trampled by cattle, but lacks hydric soils.

**Waterbody Sketch** (Include north arrow, survey boundary, and IDs of associated features)

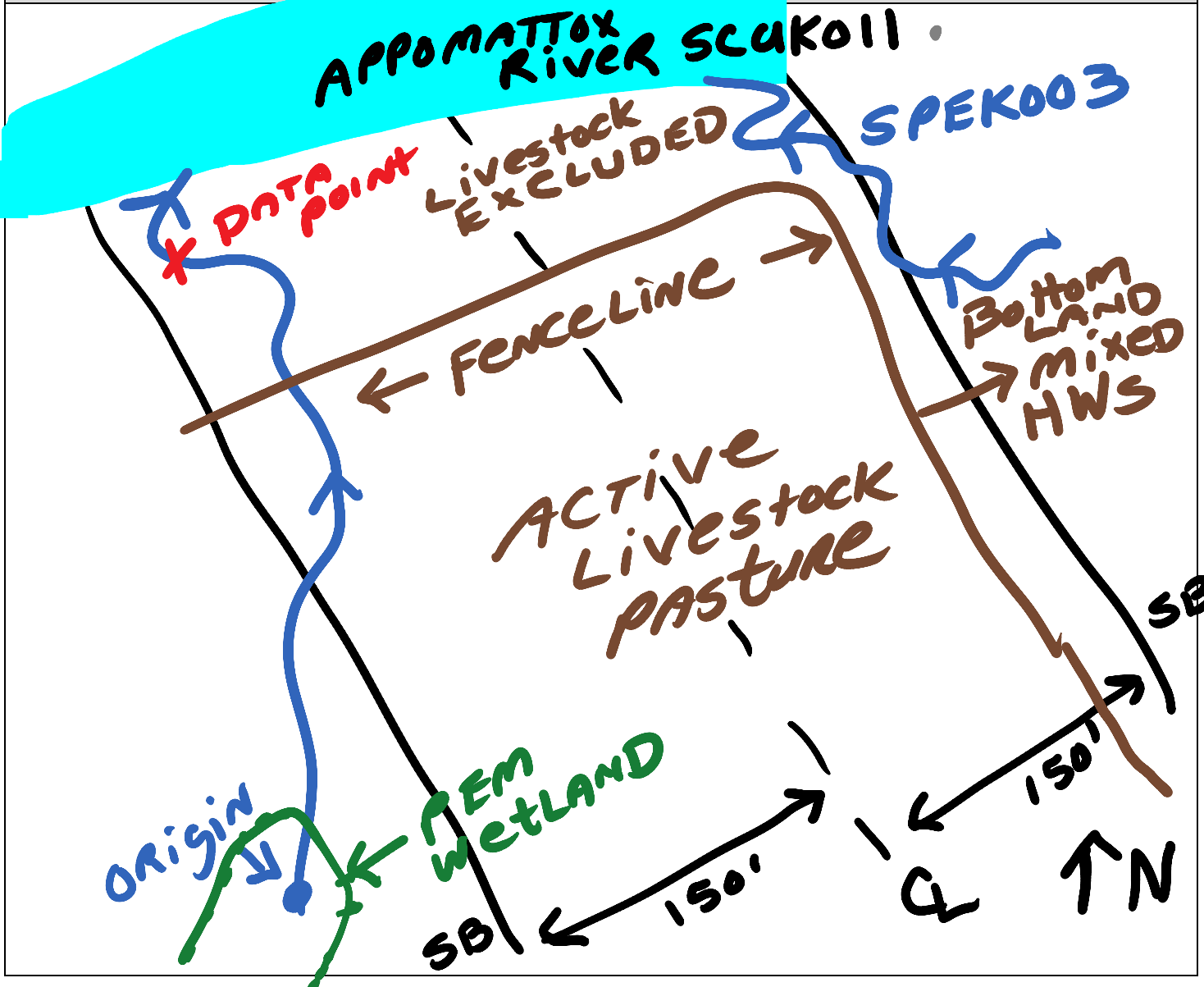



Waterbody SPEA400 facing northeast upstream



Waterbody SPEA400 facing northwest downstream



Waterbody SPEA400 facing north across

# Linear Waterbody Data Sheet

Survey Description			
Project Name: Southeast Reliability		Waterbody Name: UNNAMED TRIB TO APPOMATTOX	
Waterbody ID: SPEK003		Date: 8/1/2014	
State: Virginia	County: Prince Edward	Company: W&C	Crew Member Initials: JS, WM, JD
Photos: 104-4735 TO 4739			
Tract Number(s): 11-001		Nearest Milepost: 217	Associated Wetland ID(s): NA
Survey Type: <i>(check one)</i> <input checked="" type="checkbox"/> Centerline <input type="checkbox"/> Re-Route <input type="checkbox"/> Access Road <input type="checkbox"/> Other:			
Physical Attributes			
Stream Classification: <i>(check one)</i> <input type="checkbox"/> Ephemeral <input type="checkbox"/> Intermittent <input checked="" type="checkbox"/> Perennial			
Waterbody Type: <i>(check one)</i> <input type="checkbox"/> River <input checked="" type="checkbox"/> Stream <input type="checkbox"/> Ditch <input type="checkbox"/> Canal <input type="checkbox"/> Other:			
OHWM Width: 4 ft.		OHWM Indicator: <i>(check all that apply)</i>	
OHWM Height: 2 ft.		<input checked="" type="checkbox"/> Clear line on bank <input checked="" type="checkbox"/> Shelving <input checked="" type="checkbox"/> Wrested vegetation <input checked="" type="checkbox"/> Scouring <input checked="" type="checkbox"/> Water staining	
N/A <input type="checkbox"/>		<input checked="" type="checkbox"/> Bent, matted, or missing vegetation <input type="checkbox"/> Wrack line <input checked="" type="checkbox"/> Litter and debris <input type="checkbox"/> Abrupt plant community change <input checked="" type="checkbox"/> Soil characteristic change	
Width of Waterbody - Top of Bank to Top of Bank: 8 ft.	Width of Waterbody - Toe of Slope to Toe of Slope: 4 ft.	Width of Waterbody - Water Edge to Water Edge: 3 ft.	Depth of Water: <i>(Approx.)</i> 0.5 ft.
N/A <input type="checkbox"/>	N/A <input type="checkbox"/>	N/A <input type="checkbox"/>	N/A <input type="checkbox"/>
Sinuosity: <i>(check one)</i> <input type="checkbox"/> Straight <input checked="" type="checkbox"/> Meandering		Water velocity: <i>(Approx.)</i> 0.4 fps	
N/A <input type="checkbox"/>		N/A <input type="checkbox"/>	
Bank height Right: 7 ft. Left: 8 ft.		Bank slope Right: 80 degrees Left: 80 degrees	
Qualitative Attributes			
Water Appearance: <i>(check one)</i> <input type="checkbox"/> No water <input checked="" type="checkbox"/> Clear <input type="checkbox"/> Turbid <input type="checkbox"/> Sheen on surface <input type="checkbox"/> Surface scum <input type="checkbox"/> Algal mats <input type="checkbox"/> Other:			
Substrate: <i>(check all that apply)</i>			
<input type="checkbox"/> Bedrock <input type="checkbox"/> Boulder <input type="checkbox"/> Cobble <input checked="" type="checkbox"/> Gravel <input checked="" type="checkbox"/> Sand <input checked="" type="checkbox"/> Silt/ clay <input type="checkbox"/> Organic <input type="checkbox"/> Other:			
% of Substrate:      NA %      NA %      NA %      10 %      20 %      70 %      NA %      NA %			
Width of Riparian Zone: 100 ft.		Vegetative Layers: <i>(check all that apply)</i>	
N/A <input type="checkbox"/>		<input checked="" type="checkbox"/> Trees: <input checked="" type="checkbox"/> Saplings/Shrubs: <input checked="" type="checkbox"/> Herbs	
Avg. DBH of Dominants: <i>(approx.)</i>		16 in.      3 in.	
Dominant Bank Vegetation <i>(list)</i> : ASH, NETTLE, CAREX, RIVER OATS, CHERRYBARK OAK, IRONWOOD, MUSCADINE			
Aquatic Habitats (ex: submerged or emerged aquatic vegetation, overhanging banks/roots, leaf packs, large submerged wood, riffles, deep pools): NA			
Aquatic Organisms Observed <i>(list)</i> : COLEOPTERANS, WATER STRIDERS			
T&E Species Observed <i>(list)</i> : NA			
Disturbances (ex: livestock access, manure in waterbody, waste discharge pipes): CLEARCUT/LAND GRADING/SITE PREP NEARBY, BUT STREAM INTACT			
Tributary is: <i>(check one)</i> <input checked="" type="checkbox"/> Natural <input type="checkbox"/> Artificial, man-made <input type="checkbox"/> Manipulated			
Stream Quality <sup>3</sup> : <i>(check one)</i> <input type="checkbox"/> High <input checked="" type="checkbox"/> Moderate <input type="checkbox"/> Low			

Waterbody ID:

SPEK003

<sup>a</sup> **High Quality:** Natural channel, natural vegetation extends at least one or two active channel widths on each side; banks stable and protected by roots; water color is clear to tea-colored; no barriers to fish movement; many fish cover types available; diverse and stable aquatic habitat; no disturbance by livestock or man

**Moderate Quality:** Altered channel evidenced by rip-rap; natural vegetation extends 1/3-1/2 of the active channel width on each side; filtering function or riparian vegetation only moderately compromised; banks moderately unstable; water color is cloudy, submerged objects covered with greenish film; moderate odor; minor barriers to fish movement; fair aquatic habitat; minimum disturbance by livestock or man.

**Low Quality:** Channel is actively down cutting or widening; rip rap and channelization excessive; natural vegetation less than 1/3 of the active channel width on each side; lack of regeneration; filtering function severely compromised; banks unstable (eroding); water color is muddy and turbid; obvious pollutants (algal mats, surface scum, surface sheen); heavy odor; severe barriers to fish movement; little to no aquatic habitat; severe disturbance from livestock or man.

**Notes:**

PERENNIAL STREAM IN BOTTOMLAND HW FOREST; INCISED CHANNEL AT DATA POINT

**Waterbody Sketch** (Include north arrow, centerline, distance from centerline, data point location, survey boundary, and IDs of associated features)

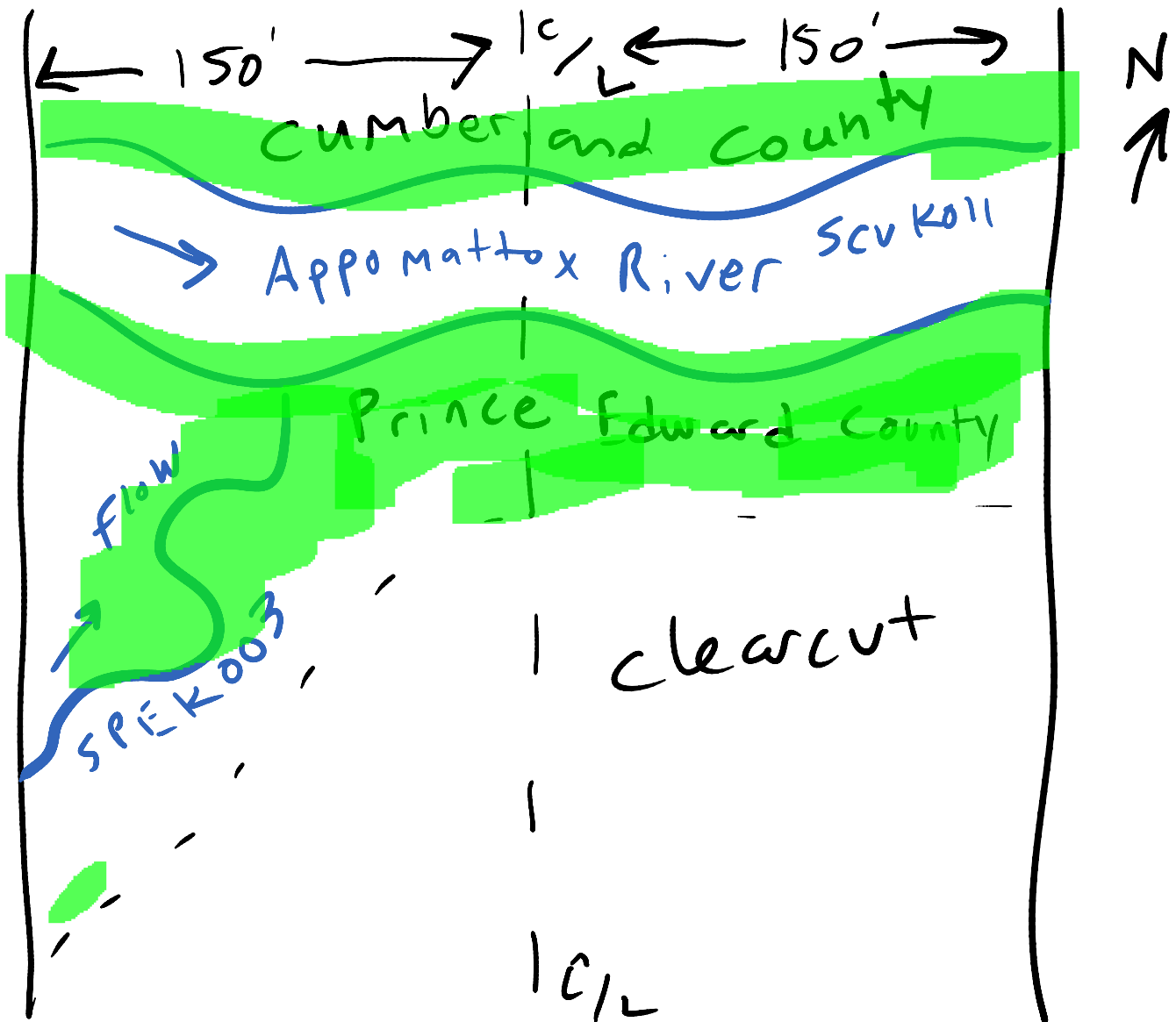



Waterbody point spek003 facing northeast and downstream



Waterbody point spek003 facing southwest and upstream



Waterbody point spek003 facing north and across



# Linear Waterbody Data Sheet

Survey Description			
Project Name: Southeast Reliability		Waterbody Name: UNNAMED TRIB TO APPOMATTOX RIVER	
Waterbody ID: SPEK004		Date: 8/2/2014	
State: Virginia	County: Prince Edward	Company: W&C	Crew Member Initials: WM, JD
Photos: 100-0406 TO 0408			
Tract Number(s): 11-021/022		Nearest Milepost: 218	Associated Wetland ID(s): NA
Survey Type: <i>(check one)</i> <input checked="" type="checkbox"/> Centerline <input type="checkbox"/> Re-Route <input type="checkbox"/> Access Road <input type="checkbox"/> Other:			
Physical Attributes			
Stream Classification: <i>(check one)</i> <input type="checkbox"/> Ephemeral <input type="checkbox"/> Intermittent <input checked="" type="checkbox"/> Perennial			
Waterbody Type: <i>(check one)</i> <input type="checkbox"/> River <input checked="" type="checkbox"/> Stream <input type="checkbox"/> Ditch <input type="checkbox"/> Canal <input type="checkbox"/> Other:			
OHWM Width: 4 ft.		OHWM Indicator: <i>(check all that apply)</i>	
OHWM Height: 1.5 ft.		<input checked="" type="checkbox"/> Clear line on bank <input checked="" type="checkbox"/> Shelving <input checked="" type="checkbox"/> Wrested vegetation <input type="checkbox"/> Scouring <input type="checkbox"/> Water staining <input type="checkbox"/> Bent, matted, or missing vegetation <input checked="" type="checkbox"/> Wrack line <input checked="" type="checkbox"/> Litter and debris <input type="checkbox"/> Abrupt plant community change <input checked="" type="checkbox"/> Soil characteristic change	
N/A <input type="checkbox"/>			
Width of Waterbody - Top of Bank to Top of Bank: 6 ft.	Width of Waterbody - Toe of Slope to Toe of Slope: 4 ft.	Width of Waterbody - Water Edge to Water Edge: 3 ft.	Depth of Water: <i>(Approx.)</i> 0.5 ft.
N/A <input type="checkbox"/>		N/A <input type="checkbox"/>	
Sinuosity: <i>(check one)</i> <input type="checkbox"/> Straight <input checked="" type="checkbox"/> Meandering		Water velocity: <i>(Approx.)</i> 0.1 fps	
N/A <input type="checkbox"/>		N/A <input type="checkbox"/>	
Bank height Right: 2 ft. Left: 4 ft.		Bank slope Right: 60 degrees Left: 60 degrees	
Qualitative Attributes			
Water Appearance: <i>(check one)</i> <input type="checkbox"/> No water <input checked="" type="checkbox"/> Clear <input type="checkbox"/> Turbid <input type="checkbox"/> Sheen on surface <input type="checkbox"/> Surface scum <input checked="" type="checkbox"/> Algal mats <input type="checkbox"/> Other:			
Substrate: <i>(check all that apply)</i>			
<input checked="" type="checkbox"/> Bedrock <input type="checkbox"/> Boulder <input type="checkbox"/> Cobble <input checked="" type="checkbox"/> Gravel <input checked="" type="checkbox"/> Sand <input checked="" type="checkbox"/> Silt/ clay <input checked="" type="checkbox"/> Organic <input type="checkbox"/> Other:			
% of Substrate:      10 %      NA %      NA %      30 %      50 %      5 %      5 %      _____ %			
Width of Riparian Zone: >100 ft.		Vegetative Layers: <i>(check all that apply)</i>	
N/A <input type="checkbox"/>		<input checked="" type="checkbox"/> Trees: <input checked="" type="checkbox"/> Saplings/Shrubs: <input checked="" type="checkbox"/> Herbs Avg. DBH of Dominants: <i>(approx.)</i> 16 in.      3 in.	
Dominant Bank Vegetation <i>(list)</i> : BEECH, TULIP POPLAR, DOGWOOD, GLYCERIA, SUGAR MAPLE, IRONWOOD, CAREX			
Aquatic Habitats (ex: submerged or emerged aquatic vegetation, overhanging banks/roots, leaf packs, large submerged wood, riffles, deep pools): POOLS/RIFFLES, SOFT SAND, LWD, OVERHANGING VEG, UNDERCUT BANKS			
Aquatic Organisms Observed <i>(list)</i> : FROGS, FISH			
T&E Species Observed <i>(list)</i> : NA			
Disturbances (ex: livestock access, manure in waterbody, waste discharge pipes): CLEARCUT/LAND GRADING/SITE PREP NEARBY, BUT STREAM INTACT			
Tributary is: <i>(check one)</i> <input checked="" type="checkbox"/> Natural <input type="checkbox"/> Artificial, man-made <input type="checkbox"/> Manipulated			
Stream Quality <sup>3</sup> : <i>(check one)</i> <input type="checkbox"/> High <input checked="" type="checkbox"/> Moderate <input type="checkbox"/> Low			

Waterbody ID:

SPEK004

<sup>a</sup> **High Quality:** Natural channel, natural vegetation extends at least one or two active channel widths on each side; banks stable and protected by roots; water color is clear to tea-colored; no barriers to fish movement; many fish cover types available; diverse and stable aquatic habitat; no disturbance by livestock or man

**Moderate Quality:** Altered channel evidenced by rip-rap; natural vegetation extends 1/3-1/2 of the active channel width on each side; filtering function or riparian vegetation only moderately compromised; banks moderately unstable; water color is cloudy, submerged objects covered with greenish film; moderate odor; minor barriers to fish movement; fair aquatic habitat; minimum disturbance by livestock or man.

**Low Quality:** Channel is actively down cutting or widening; rip rap and channelization excessive; natural vegetation less than 1/3 of the active channel width on each side; lack of regeneration; filtering function severely compromised; banks unstable (eroding); water color is muddy and turbid; obvious pollutants (algal mats, surface scum, surface sheen); heavy odor; severe barriers to fish movement; little to no aquatic habitat; severe disturbance from livestock or man.

**Notes:**

PERENNIAL STREAM IN HARDWOOD FOREST; WELL CONNECTED TO SMALL FLOODPLAIN AREA; GOOD AQUATIC HABITAT; SOME SEEPY STREAMBANK AREAS

**Waterbody Sketch** (Include north arrow, centerline, distance from centerline, data point location, survey boundary, and IDs of associated features)

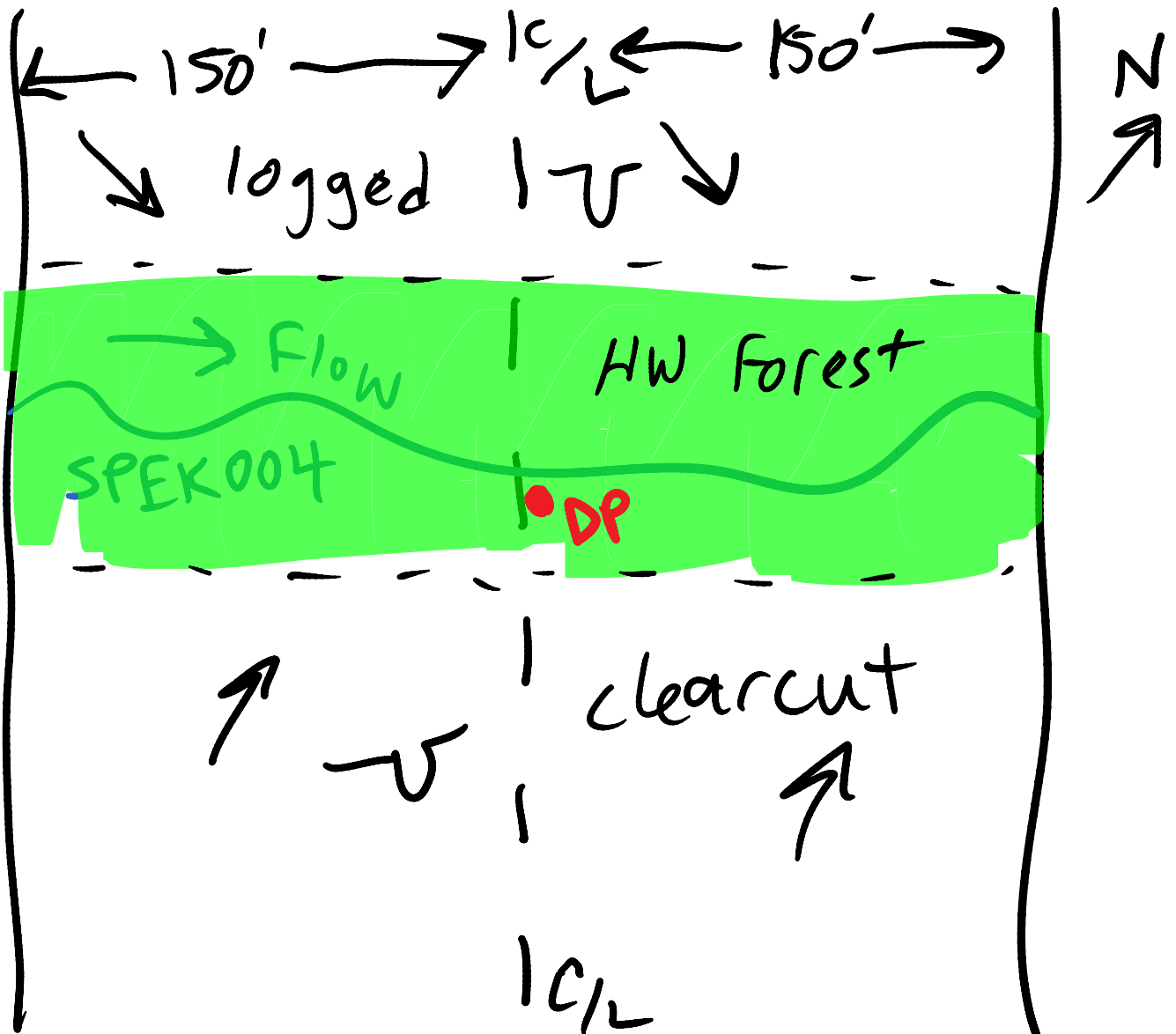



Waterbody point spek004 facing South and upstream



Waterbody point spek004 facing North and downstream



Waterbody point spek004 facing East and across

# Linear Waterbody Data Sheet

Survey Description			
Project Name: Southeast Reliability		Waterbody Name: UNNAMED TRIB TO APPOMATTOX RIVER	
Waterbody ID: SPEK006		Date: 8/2/2014	
State: Virginia	County: Prince Edward	Company: W&C	Crew Member Initials: WM, JD
Photos: 100-0426 TO 0428			
Tract Number(s): 11-022		Nearest Milepost: 218	Associated Wetland ID(s): WPEK001
Survey Type: <i>(check one)</i> <input checked="" type="checkbox"/> Centerline <input type="checkbox"/> Re-Route <input type="checkbox"/> Access Road <input type="checkbox"/> Other:			
Physical Attributes			
Stream Classification: <i>(check one)</i> <input type="checkbox"/> Ephemeral <input type="checkbox"/> Intermittent <input checked="" type="checkbox"/> Perennial			
Waterbody Type: <i>(check one)</i> <input type="checkbox"/> River <input checked="" type="checkbox"/> Stream <input type="checkbox"/> Ditch <input type="checkbox"/> Canal <input type="checkbox"/> Other:			
OHWM Width: 9 ft.		OHWM Indicator: <i>(check all that apply)</i> <input checked="" type="checkbox"/> Clear line on bank <input checked="" type="checkbox"/> Shelving <input checked="" type="checkbox"/> Wrested vegetation <input type="checkbox"/> Scouring <input type="checkbox"/> Water staining	
OHWM Height: 2 ft.		<input checked="" type="checkbox"/> Bent, matted, or missing vegetation <input checked="" type="checkbox"/> Wrack line <input checked="" type="checkbox"/> Litter and debris <input type="checkbox"/> Abrupt plant community change <input checked="" type="checkbox"/> Soil characteristic change	
N/A <input type="checkbox"/>			
Width of Waterbody - Top of Bank to Top of Bank: 15 ft.	Width of Waterbody - Toe of Slope to Toe of Slope: 9 ft.	Width of Waterbody - Water Edge to Water Edge: 3 ft.	Depth of Water: <i>(Approx.)</i> 0.5 ft.
N/A <input type="checkbox"/>		N/A <input type="checkbox"/>	
Sinuosity: <i>(check one)</i> <input type="checkbox"/> Straight <input checked="" type="checkbox"/> Meandering		Water velocity: <i>(Approx.)</i> 0.1 fps	
N/A <input type="checkbox"/>		N/A <input type="checkbox"/>	
Bank height Right: 6 ft. Left: 5 ft.		Bank slope Right: 60 degrees Left: 60 degrees	
Qualitative Attributes			
Water Appearance: <i>(check one)</i> <input type="checkbox"/> No water <input checked="" type="checkbox"/> Clear <input type="checkbox"/> Turbid <input type="checkbox"/> Sheen on surface <input type="checkbox"/> Surface scum <input checked="" type="checkbox"/> Algal mats <input type="checkbox"/> Other:			
Substrate: <i>(check all that apply)</i> <input checked="" type="checkbox"/> Bedrock <input type="checkbox"/> Boulder <input checked="" type="checkbox"/> Cobble <input checked="" type="checkbox"/> Gravel <input checked="" type="checkbox"/> Sand <input checked="" type="checkbox"/> Silt/ clay <input checked="" type="checkbox"/> Organic <input type="checkbox"/> Other:			
% of Substrate:      5 %      NA %      10 %      30 %      45 %      5 %      5 %      _____ %			
Width of Riparian Zone: >100 ft.		Vegetative Layers: <i>(check all that apply)</i> <input checked="" type="checkbox"/> Trees: <input checked="" type="checkbox"/> Saplings/Shrubs: <input checked="" type="checkbox"/> Herbs	
N/A <input type="checkbox"/>		Avg. DBH of Dominants: <i>(approx.)</i> 16 in.      3 in.	
Dominant Bank Vegetation <i>(list)</i> : BEECH, TULIP POPLAR, DOGWOOD, CHRISTMAS FERN, SUGAR MAPLE, HELIANTHUS, CAREX, ELDERBERRY			
Aquatic Habitats (ex: submerged or emerged aquatic vegetation, overhanging banks/roots, leaf packs, large submerged wood, riffles, deep pools): POOLS/RIFFLES, SOFT SAND, LWD, OVERHANGING VEG, UNDERCUT BANKS			
Aquatic Organisms Observed <i>(list)</i> : FROGS, FISH, CRUSTACEAN, MAYFLIES, WATER STRIDER			
T&E Species Observed <i>(list)</i> : NA			
Disturbances (ex: livestock access, manure in waterbody, waste discharge pipes): CLEARCUT/LAND GRADING/SITE PREP NEARBY, BUT STREAM INTACT			
Tributary is: <i>(check one)</i> <input checked="" type="checkbox"/> Natural <input type="checkbox"/> Artificial, man-made <input type="checkbox"/> Manipulated			
Stream Quality <sup>3</sup> : <i>(check one)</i> <input type="checkbox"/> High <input checked="" type="checkbox"/> Moderate <input type="checkbox"/> Low			

Waterbody ID:  
SPEK006

<sup>a</sup> **High Quality:** Natural channel, natural vegetation extends at least one or two active channel widths on each side; banks stable and protected by roots; water color is clear to tea-colored; no barriers to fish movement; many fish cover types available; diverse and stable aquatic habitat; no disturbance by livestock or man

**Moderate Quality:** Altered channel evidenced by rip-rap; natural vegetation extends 1/3-1/2 of the active channel width on each side; filtering function or riparian vegetation only moderately compromised; banks moderately unstable; water color is cloudy, submerged objects covered with greenish film; moderate odor; minor barriers to fish movement; fair aquatic habitat; minimum disturbance by livestock or man.

**Low Quality:** Channel is actively down cutting or widening; rip rap and channelization excessive; natural vegetation less than 1/3 of the active channel width on each side; lack of regeneration; filtering function severely compromised; banks unstable (eroding); water color is muddy and turbid; obvious pollutants (algal mats, surface scum, surface sheen); heavy odor; severe barriers to fish movement; little to no aquatic habitat; severe disturbance from livestock or man.

**Notes:**

PERENNIAL STREAM IN HARDWOOD FOREST; WELL CONNECTED TO SMALL FLOODPLAIN AREA; GOOD AQUATIC HABITAT; SOME SEEPY STREAMBANK AREAS

**Waterbody Sketch** (Include north arrow, centerline, distance from centerline, data point location, survey boundary, and IDs of associated features)

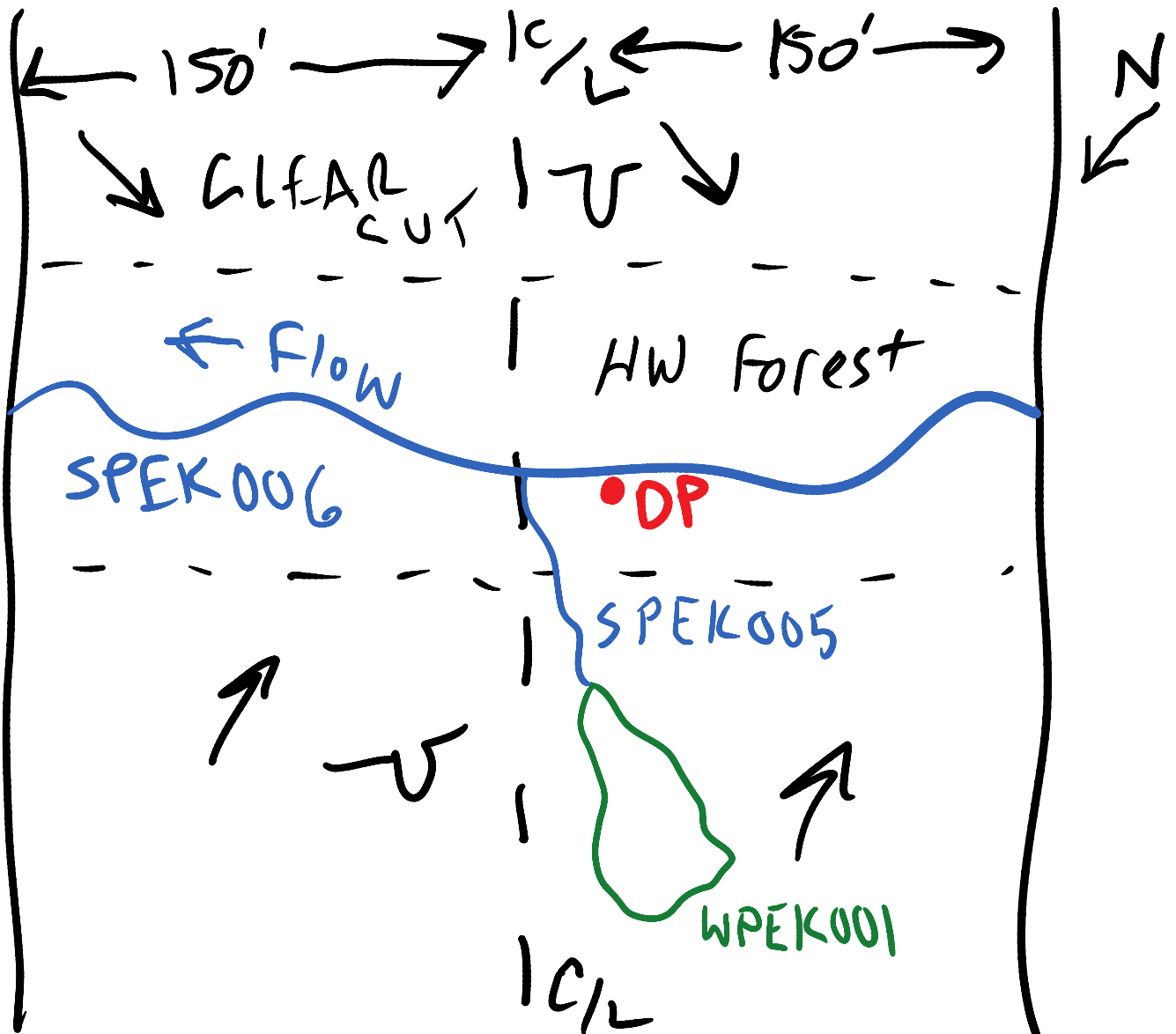



Waterbody point spek006 facing North and  
downstream



Waterbody point spek006 facing South and  
upstream



Waterbody point spek006 facing East and across



# Linear Waterbody Data Sheet

Survey Description			
Project Name: Southeast Reliability		Waterbody Name: UNNAMED TRIB TO APPOMATTOX RIVER	
Waterbody ID: SPEK005		Date: 8/2/2014	
State: Virginia	County: Prince Edward	Company: W&C	Crew Member Initials: WM, JD
Photos: 100-0423 To 0425			
Tract Number(s): 11-022		Nearest Milepost: 218	Associated Wetland ID(s): WPEK001
Survey Type: <i>(check one)</i> <input checked="" type="checkbox"/> Centerline <input type="checkbox"/> Re-Route <input type="checkbox"/> Access Road <input type="checkbox"/> Other:			
Physical Attributes			
Stream Classification: <i>(check one)</i> <input checked="" type="checkbox"/> Ephemeral <input type="checkbox"/> Intermittent <input type="checkbox"/> Perennial			
Waterbody Type: <i>(check one)</i> <input type="checkbox"/> River <input checked="" type="checkbox"/> Stream <input type="checkbox"/> Ditch <input type="checkbox"/> Canal <input type="checkbox"/> Other:			
OHWM Width: _ 1 ft.		OHWM Indicator: <i>(check all that apply)</i>	
Height: _ 0.5 ft.		<input checked="" type="checkbox"/> Clear line on bank <input type="checkbox"/> Shelving <input checked="" type="checkbox"/> Wrested vegetation <input type="checkbox"/> Scouring <input type="checkbox"/> Water staining	
N/A <input type="checkbox"/>		<input checked="" type="checkbox"/> Bent, matted, or missing vegetation <input type="checkbox"/> Wrack line <input checked="" type="checkbox"/> Litter and debris <input type="checkbox"/> Abrupt plant community change <input checked="" type="checkbox"/> Soil characteristic change	
Width of Waterbody - Top of Bank to Top of Bank: _ 2 ft.	Width of Waterbody - Toe of Slope to Toe of Slope: _ 1 ft.	Width of Waterbody - Water Edge to Water Edge: N/A <input checked="" type="checkbox"/> ___ ft.	Depth of Water: <i>(Approx.)</i> N/A <input checked="" type="checkbox"/> ___ ft.
Sinuosity: <i>(check one)</i> <input type="checkbox"/> Straight <input checked="" type="checkbox"/> Meandering	Water velocity: <i>(Approx.)</i> ___ fps N/A <input checked="" type="checkbox"/>	Bank height Right: _ 0.75 ft. Left: _ 0.75 ft.	Bank slope Right: _ 70 degrees Left: _ 70 degrees
Qualitative Attributes			
Water Appearance: <i>(check one)</i> <input checked="" type="checkbox"/> No water <input type="checkbox"/> Clear <input type="checkbox"/> Turbid <input type="checkbox"/> Sheen on surface <input type="checkbox"/> Surface scum <input type="checkbox"/> Algal mats <input type="checkbox"/> Other:			
Substrate: <i>(check all that apply)</i>			
% of Substrate: <u>NA</u> % <u>NA</u> % <u>NA</u> % <u>5</u> % <u>30</u> % <u>55</u> % <u>10</u> %      _____ %			
Width of Riparian Zone: N/A <input type="checkbox"/> >100 ft.		Vegetative Layers: <i>(check all that apply)</i> <input checked="" type="checkbox"/> Trees: <input checked="" type="checkbox"/> Saplings/Shrubs: <input checked="" type="checkbox"/> Herbs	
Avg. DBH of Dominants: <i>(approx.)</i> <u>16</u> in.		<u>3</u> in.	
Dominant Bank Vegetation <i>(list)</i> : BEECH, TULIP POPLAR, DOGWOOD, REDBUD, XMAS FERN, VIRGINIA CREEPER, CAREX			
Aquatic Habitats (ex: submerged or emerged aquatic vegetation, overhanging banks/roots, leaf packs, large submerged wood, riffles, deep pools): NA			
Aquatic Organisms Observed <i>(list)</i> : NA			
T&E Species Observed <i>(list)</i> : NA			
Disturbances (ex: livestock access, manure in waterbody, waste discharge pipes): CLEARCUT/LAND GRADING/SITE PREP NEARBY			
Tributary is: <i>(check one)</i> <input checked="" type="checkbox"/> Natural <input type="checkbox"/> Artificial, man-made <input type="checkbox"/> Manipulated			
Stream Quality <sup>3</sup> : <i>(check one)</i> <input type="checkbox"/> High <input type="checkbox"/> Moderate <input checked="" type="checkbox"/> Low			

Waterbody ID:

SPEK005

<sup>a</sup> **High Quality:** Natural channel, natural vegetation extends at least one or two active channel widths on each side; banks stable and protected by roots; water color is clear to tea-colored; no barriers to fish movement; many fish cover types available; diverse and stable aquatic habitat; no disturbance by livestock or man

**Moderate Quality:** Altered channel evidenced by rip-rap; natural vegetation extends 1/3-1/2 of the active channel width on each side; filtering function or riparian vegetation only moderately compromised; banks moderately unstable; water color is cloudy, submerged objects covered with greenish film; moderate odor; minor barriers to fish movement; fair aquatic habitat; minimum disturbance by livestock or man.

**Low Quality:** Channel is actively down cutting or widening; rip rap and channelization excessive; natural vegetation less than 1/3 of the active channel width on each side; lack of regeneration; filtering function severely compromised; banks unstable (eroding); water color is muddy and turbid; obvious pollutants (algal mats, surface scum, surface sheen); heavy odor; severe barriers to fish movement; little to no aquatic habitat; severe disturbance from livestock or man.

**Notes:**

EPHEMERAL STREAM IN HARDWOOD FOREST; NOT CONNECTED TO FLOODPLAIN AREA; DRAINS UPSTREAM HILLSIDE WETLAND AREA

**Waterbody Sketch** (Include north arrow, centerline, distance from centerline, data point location, survey boundary, and IDs of associated features)

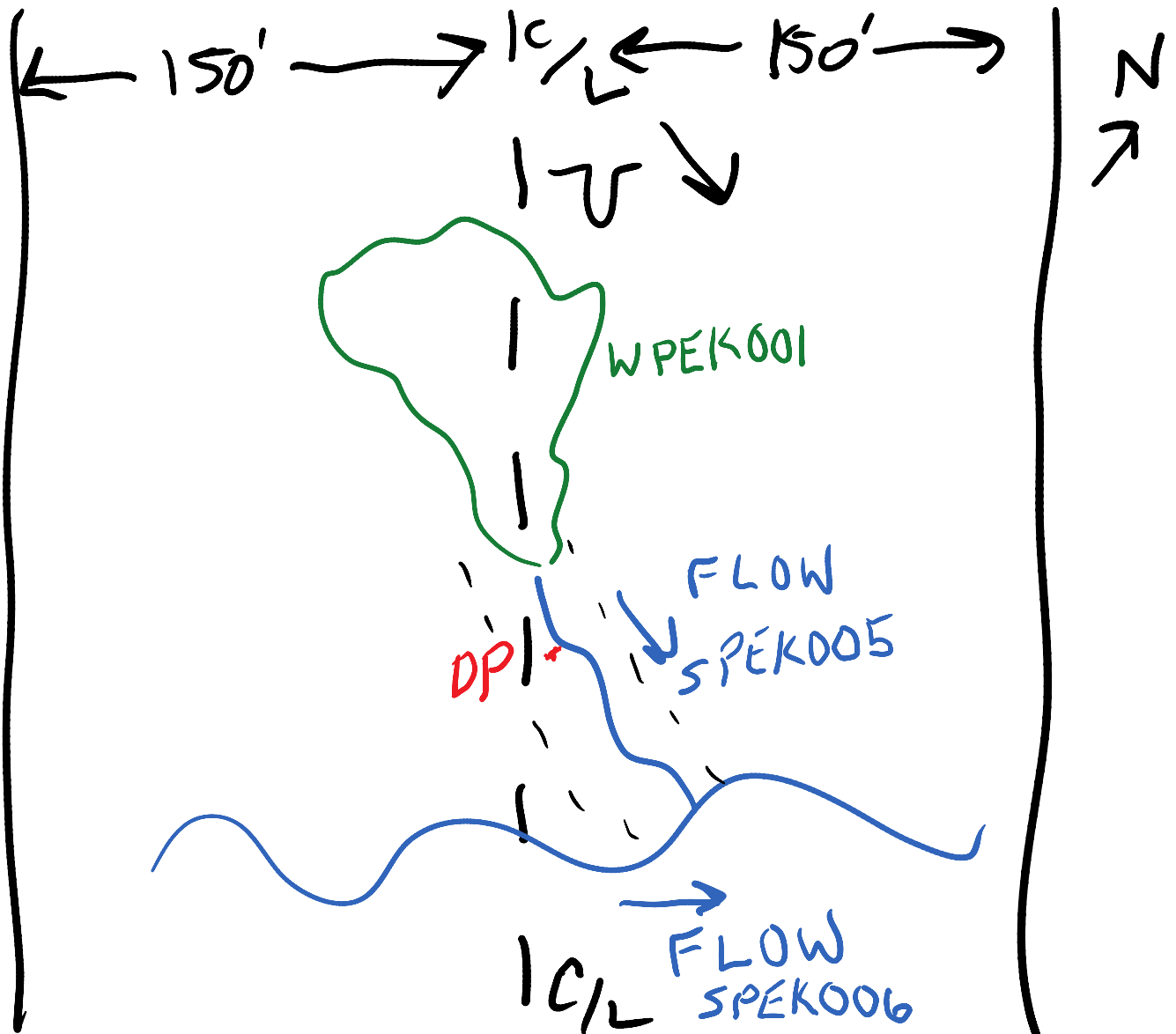



Waterbody point spek005 facing West and upstream



Waterbody point spek005 facing East and downstream



Waterbody point spek005 facing South and across

# Linear Waterbody Data Sheet

Survey Description			
Project Name: Southeast Reliability		Waterbody Name: UNNAMED TRIB TO APPOMATTOX RIVER	
Waterbody ID: SPEK007		Date: 8/2/2014	
State: Virginia	County: Prince Edward	Company: W&C	Crew Member Initials: WM, JD
Photos: 100-0429 TO 0431			
Tract Number(s): 11-024		Nearest Milepost: 218	Associated Wetland ID(s): NA
Survey Type: <i>(check one)</i> <input checked="" type="checkbox"/> Centerline <input type="checkbox"/> Re-Route <input type="checkbox"/> Access Road <input type="checkbox"/> Other:			
Physical Attributes			
Stream Classification: <i>(check one)</i> <input type="checkbox"/> Ephemeral <input checked="" type="checkbox"/> Intermittent <input type="checkbox"/> Perennial			
Waterbody Type: <i>(check one)</i> <input type="checkbox"/> River <input checked="" type="checkbox"/> Stream <input type="checkbox"/> Ditch <input type="checkbox"/> Canal <input type="checkbox"/> Other:			
OHWM Width: 2 ft.		OHWM Indicator: <i>(check all that apply)</i> <input type="checkbox"/> Clear line on bank <input type="checkbox"/> Shelving <input type="checkbox"/> Wrested vegetation <input type="checkbox"/> Scouring <input checked="" type="checkbox"/> Water staining	
OHWM Height: 0.5 ft.		<input checked="" type="checkbox"/> Bent, matted, or missing vegetation <input type="checkbox"/> Wrack line <input checked="" type="checkbox"/> Litter and debris <input checked="" type="checkbox"/> Abrupt plant community change <input checked="" type="checkbox"/> Soil characteristic change	
N/A <input type="checkbox"/>			
Width of Waterbody - Top of Bank to Top of Bank: 12 ft.	Width of Waterbody - Toe of Slope to Toe of Slope: 2 ft.	Width of Waterbody - Water Edge to Water Edge: 1 ft.	Depth of Water: <i>(Approx.)</i> 0.1 ft.
N/A <input type="checkbox"/>		N/A <input type="checkbox"/>	
Sinuosity: <i>(check one)</i> <input type="checkbox"/> Straight <input checked="" type="checkbox"/> Meandering		Water velocity: <i>(Approx.)</i> 0.01 fps	
N/A <input type="checkbox"/>		N/A <input type="checkbox"/>	
Bank height Right: 9 ft. Left: 8 ft.		Bank slope Right: 80 degrees Left: 80 degrees	
Qualitative Attributes			
Water Appearance: <i>(check one)</i> <input type="checkbox"/> No water <input type="checkbox"/> Clear <input type="checkbox"/> Turbid <input type="checkbox"/> Sheen on surface <input type="checkbox"/> Surface scum <input checked="" type="checkbox"/> Algal mats <input checked="" type="checkbox"/> Other: FE-OXIDIZING BACTERIA			
Substrate: <i>(check all that apply)</i> % of Substrate:      NA %      NA %      NA %      NA %      70 %      15 %      15 %      _____ %			
Width of Riparian Zone: 100 ft.		Vegetative Layers: <i>(check all that apply)</i> <input checked="" type="checkbox"/> Trees: <input checked="" type="checkbox"/> Saplings/Shrubs: <input checked="" type="checkbox"/> Herbs	
N/A <input type="checkbox"/>		Avg. DBH of Dominants: <i>(approx.)</i> 10 in.      3 in.	
Dominant Bank Vegetation <i>(list)</i> : BEECH, SWEETGUM, BLACK WALNUT, SOURWOOD, RUBUS, POKEWEEED, JAPANESE HONEYSUCKLE			
Aquatic Habitats (ex: submerged or emerged aquatic vegetation, overhanging banks/roots, leaf packs, large submerged wood, riffles, deep pools): SOFT SAND, LWD, OVERHANGING VEG			
Aquatic Organisms Observed <i>(list)</i> : FROGS			
T&E Species Observed <i>(list)</i> : NA			
Disturbances (ex: livestock access, manure in waterbody, waste discharge pipes): CLEARCUT/LAND GRADING/SITE PREP NEARBY; LOGGING DEBRIS PILED IN STREAM			
Tributary is: <i>(check one)</i> <input checked="" type="checkbox"/> Natural <input type="checkbox"/> Artificial, man-made <input type="checkbox"/> Manipulated			
Stream Quality <sup>3</sup> : <i>(check one)</i> <input type="checkbox"/> High <input type="checkbox"/> Moderate <input checked="" type="checkbox"/> Low			

<sup>a</sup> **High Quality:** Natural channel, natural vegetation extends at least one or two active channel widths on each side; banks stable and protected by roots; water color is clear to tea-colored; no barriers to fish movement; many fish cover types available; diverse and stable aquatic habitat; no disturbance by livestock or man

**Moderate Quality:** Altered channel evidenced by rip-rap; natural vegetation extends 1/3-1/2 of the active channel width on each side; filtering function or riparian vegetation only moderately compromised; banks moderately unstable; water color is cloudy, submerged objects covered with greenish film; moderate odor; minor barriers to fish movement; fair aquatic habitat; minimum disturbance by livestock or man.

**Low Quality:** Channel is actively down cutting or widening; rip rap and channelization excessive; natural vegetation less than 1/3 of the active channel width on each side; lack of regeneration; filtering function severely compromised; banks unstable (eroding); water color is muddy and turbid; obvious pollutants (algal mats, surface scum, surface sheen); heavy odor; severe barriers to fish movement; little to no aquatic habitat; severe disturbance from livestock or man.

**Notes:**

HEADWATER INTERMITTENT STREAM IN CLEARCUT; POOR AQUATIC HABITAT; SOME SEEPY STREAMBANK AREAS

**Waterbody Sketch** (Include north arrow, centerline, distance from centerline, data point location, survey boundary, and IDs of associated features)

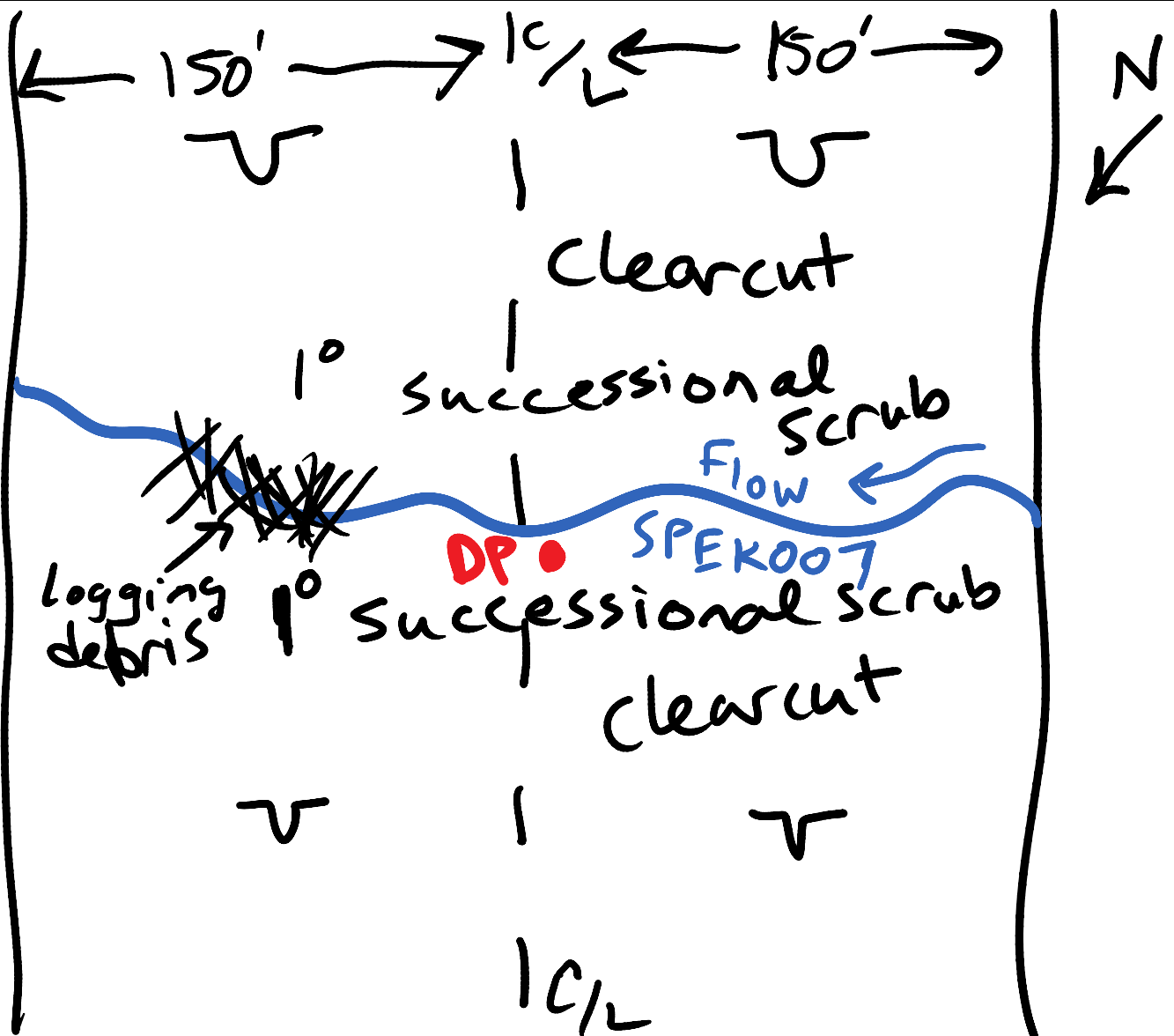



Waterbody point spek007 facing South and upstream



Waterbody point spek007 facing North and downstream



Waterbody point spek007 facing East and across



# Linear Waterbody Data Sheet

Survey Description			
Project Name: Southeast Reliability		Waterbody Name: UNNAMED TRIB TO APPOMATTOX RIVER	
Waterbody ID: SPEK008		Date: 8/2/2014	
State: Virginia	County: Prince Edward	Company: W&C	Crew Member Initials: WM, JD
Photos: 100-0434 TO 0437			
Tract Number(s): 11-024		Nearest Milepost: 217	Associated Wetland ID(s): NA
Survey Type: <i>(check one)</i> <input checked="" type="checkbox"/> Centerline <input type="checkbox"/> Re-Route <input type="checkbox"/> Access Road <input type="checkbox"/> Other:			
Physical Attributes			
Stream Classification: <i>(check one)</i> Ephemeral <input checked="" type="checkbox"/> Intermittent      Perennial			
Waterbody Type: <i>(check one)</i> <input type="checkbox"/> River <input checked="" type="checkbox"/> Stream <input type="checkbox"/> Ditch <input type="checkbox"/> Canal <input type="checkbox"/> Other:			
OHWM Width: 2 ft.		OHWM Indicator: <i>(check all that apply)</i>	
OHWM Height: 0.5 ft.		<input type="checkbox"/> Clear line on bank <input checked="" type="checkbox"/> Shelving <input checked="" type="checkbox"/> Wrested vegetation <input checked="" type="checkbox"/> Scouring <input type="checkbox"/> Water staining <input type="checkbox"/> Bent, matted, or missing vegetation <input type="checkbox"/> Wrack line <input checked="" type="checkbox"/> Litter and debris <input checked="" type="checkbox"/> Abrupt plant community change <input checked="" type="checkbox"/> Soil characteristic change	
N/A <input type="checkbox"/>			
Width of Waterbody - Top of Bank to Top of Bank: 10 ft.	Width of Waterbody - Toe of Slope to Toe of Slope: 2 ft.	Width of Waterbody - Water Edge to Water Edge: 0.5 ft.	Depth of Water: <i>(Approx.)</i> 0.1 ft.
N/A <input type="checkbox"/>		N/A <input type="checkbox"/>	
Sinuosity: <i>(check one)</i> <input type="checkbox"/> Straight <input checked="" type="checkbox"/> Meandering		Water velocity: <i>(Approx.)</i> 0.01 fps	Bank height: Right: 4 ft. Left: 4 ft.
N/A <input type="checkbox"/>		Bank slope: Right: 30 degrees Left: 60 degrees	
N/A <input type="checkbox"/>		N/A <input type="checkbox"/>	
Qualitative Attributes			
Water Appearance: <i>(check one)</i> <input type="checkbox"/> No water <input checked="" type="checkbox"/> Clear <input type="checkbox"/> Turbid <input type="checkbox"/> Sheen on surface <input type="checkbox"/> Surface scum <input type="checkbox"/> Algal mats <input type="checkbox"/> Other:			
Substrate: <i>(check all that apply)</i>			
<input type="checkbox"/> Bedrock <input type="checkbox"/> Boulder <input checked="" type="checkbox"/> Cobble <input checked="" type="checkbox"/> Gravel <input checked="" type="checkbox"/> Sand <input checked="" type="checkbox"/> Silt/ clay <input type="checkbox"/> Organic <input type="checkbox"/> Other:			
% of Substrate:      NA %      NA %      5 %      25 %      20 %      50 %      NA %      _____ %			
Width of Riparian Zone: 100 ft.		Vegetative Layers: <i>(check all that apply)</i>	
N/A <input type="checkbox"/>		<input type="checkbox"/> Trees: <input checked="" type="checkbox"/> Saplings/Shrubs: <input checked="" type="checkbox"/> Herbs Avg. DBH of Dominants: <i>(approx.)</i> ___ in.      3 in.	
Dominant Bank Vegetation <i>(list)</i> : BEECH, RED MAPLE, TULIP POPLAR, RUBUS, POKEWEED, CHRISTMAS FERN, JAPANESE HONEYSUCKLE			
Aquatic Habitats (ex: submerged or emerged aquatic vegetation, overhanging banks/roots, leaf packs, large submerged wood, riffles, deep pools): COBBLE-GRAVEL, OVERHANGING VEG			
Aquatic Organisms Observed <i>(list)</i> : NA			
T&E Species Observed <i>(list)</i> : NA			
Disturbances (ex: livestock access, manure in waterbody, waste discharge pipes): CLEARCUT/LAND GRADING/SITE PREP NEARBY; LOGGING DEBRIS PILED IN STREAM			
Tributary is: <i>(check one)</i> <input checked="" type="checkbox"/> Natural <input type="checkbox"/> Artificial, man-made <input type="checkbox"/> Manipulated			
Stream Quality <sup>3</sup> : <i>(check one)</i> <input type="checkbox"/> High <input type="checkbox"/> Moderate <input checked="" type="checkbox"/> Low			

<sup>a</sup> **High Quality:** Natural channel, natural vegetation extends at least one or two active channel widths on each side; banks stable and protected by roots; water color is clear to tea-colored; no barriers to fish movement; many fish cover types available; diverse and stable aquatic habitat; no disturbance by livestock or man

**Moderate Quality:** Altered channel evidenced by rip-rap; natural vegetation extends 1/3-1/2 of the active channel width on each side; filtering function or riparian vegetation only moderately compromised; banks moderately unstable; water color is cloudy, submerged objects covered with greenish film; moderate odor; minor barriers to fish movement; fair aquatic habitat; minimum disturbance by livestock or man.

**Low Quality:** Channel is actively down cutting or widening; rip rap and channelization excessive; natural vegetation less than 1/3 of the active channel width on each side; lack of regeneration; filtering function severely compromised; banks unstable (eroding); water color is muddy and turbid; obvious pollutants (algal mats, surface scum, surface sheen); heavy odor; severe barriers to fish movement; little to no aquatic habitat; severe disturbance from livestock or man.

**Notes:**

HEADWATER INTERMITTENT STREAM IN CLEARCUT; POOR AQUATIC HABITAT; SOME SEEPY STREAMBANK AREAS

**Waterbody Sketch** (Include north arrow, centerline, distance from centerline, data point location, survey boundary, and IDs of associated features)

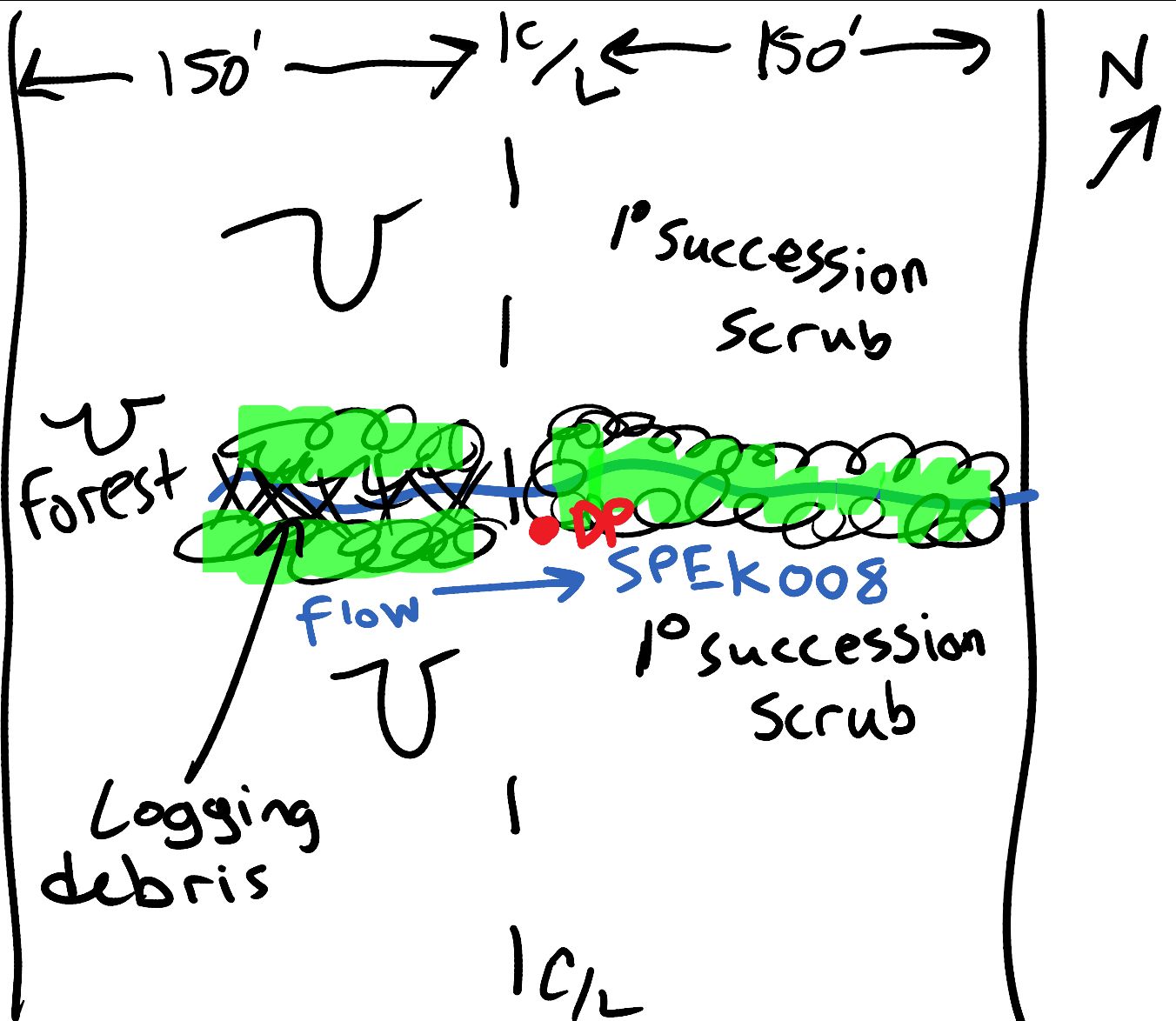



Waterbody point spek008 facing South and upstream



Waterbody point spek008 facing North and downstream



Waterbody point spek008 facing West and across

# Linear Waterbody Data Sheet

Survey Description			
Project Name: Southeast Reliability		Waterbody Name: UNNAMED TRIB TO APPOMATTOX RIVER	
Waterbody ID: SPEK009		Date: 8/2/2014	
State: Virginia	County: Prince Edward	Company: W&C	Crew Member Initials: WM, JD
Photos: 100-0438 TO 0440			
Tract Number(s): 11-024		Nearest Milepost: 218	Associated Wetland ID(s): NA
Survey Type: <i>(check one)</i> <input checked="" type="checkbox"/> Centerline <input type="checkbox"/> Re-Route <input type="checkbox"/> Access Road <input type="checkbox"/> Other:			
Physical Attributes			
Stream Classification: <i>(check one)</i> <input type="checkbox"/> Ephemeral <input type="checkbox"/> Intermittent <input checked="" type="checkbox"/> Perennial			
Waterbody Type: <i>(check one)</i> <input type="checkbox"/> River <input checked="" type="checkbox"/> Stream <input type="checkbox"/> Ditch <input type="checkbox"/> Canal <input type="checkbox"/> Other:			
OHWM Width: 4 ft.		OHWM Indicator: <i>(check all that apply)</i>	
OHWM Height: 2 ft.		<input checked="" type="checkbox"/> Clear line on bank <input checked="" type="checkbox"/> Shelving <input checked="" type="checkbox"/> Wrested vegetation <input checked="" type="checkbox"/> Scouring <input type="checkbox"/> Water staining	
N/A <input type="checkbox"/>		<input type="checkbox"/> Bent, matted, or missing vegetation <input type="checkbox"/> Wrack line <input checked="" type="checkbox"/> Litter and debris <input type="checkbox"/> Abrupt plant community change <input checked="" type="checkbox"/> Soil characteristic change	
Width of Waterbody - Top of Bank to Top of Bank: 14 ft.	Width of Waterbody - Toe of Slope to Toe of Slope: 4 ft.	Width of Waterbody - Water Edge to Water Edge: 3 ft.	Depth of Water: <i>(Approx.)</i> 0.5 ft.
N/A <input type="checkbox"/>	N/A <input type="checkbox"/>	N/A <input type="checkbox"/>	N/A <input type="checkbox"/>
Sinuosity: <i>(check one)</i> <input type="checkbox"/> Straight <input checked="" type="checkbox"/> Meandering		Water velocity: <i>(Approx.)</i> 0.1 fps	
N/A <input type="checkbox"/>		N/A <input type="checkbox"/>	
Bank height Right: 10 ft. Left: 10 ft.		Bank slope Right: 80 degrees Left: 80 degrees	
Qualitative Attributes			
Water Appearance: <i>(check one)</i> <input type="checkbox"/> No water <input checked="" type="checkbox"/> Clear <input type="checkbox"/> Turbid <input type="checkbox"/> Sheen on surface <input type="checkbox"/> Surface scum <input type="checkbox"/> Algal mats <input type="checkbox"/> Other:			
Substrate: <i>(check all that apply)</i>			
<input checked="" type="checkbox"/> Bedrock <input checked="" type="checkbox"/> Boulder <input checked="" type="checkbox"/> Cobble <input checked="" type="checkbox"/> Gravel <input checked="" type="checkbox"/> Sand <input checked="" type="checkbox"/> Silt/ clay <input type="checkbox"/> Organic <input type="checkbox"/> Other:			
% of Substrate:      15 %      10 %      15 %      25 %      25 %      10 %      NA %      _____ %			
Width of Riparian Zone: 100 ft.		Vegetative Layers: <i>(check all that apply)</i>	
N/A <input type="checkbox"/>		<input checked="" type="checkbox"/> Trees: <input checked="" type="checkbox"/> Saplings/Shrubs: <input checked="" type="checkbox"/> Herbs	
Avg. DBH of Dominants: <i>(approx.)</i>		14 in.      3 in.	
Dominant Bank Vegetation <i>(list)</i> : BEECH, QUERCUS SPP., TULIP POPLAR, SWEETGUM, DEER TONGUE, HOLLY, XMAS FERN, MUSCADINE			
Aquatic Habitats (ex: submerged or emerged aquatic vegetation, overhanging banks/roots, leaf packs, large submerged wood, riffles, deep pools): COBBLE-GRAVEL, UNDERCUT BANKS, LWD, OVERHANGING VEG			
Aquatic Organisms Observed <i>(list)</i> : EPT, FISH, CRAYFISH			
T&E Species Observed <i>(list)</i> : NA			
Disturbances (ex: livestock access, manure in waterbody, waste discharge pipes): PERENNIAL STREAM IN HARDWOOD FOREST; STABLE			
Tributary is: <i>(check one)</i> <input checked="" type="checkbox"/> Natural <input type="checkbox"/> Artificial, man-made <input type="checkbox"/> Manipulated			
Stream Quality <sup>3</sup> : <i>(check one)</i> <input checked="" type="checkbox"/> High <input type="checkbox"/> Moderate <input type="checkbox"/> Low			

Waterbody ID:

SPEK009

<sup>a</sup> **High Quality:** Natural channel, natural vegetation extends at least one or two active channel widths on each side; banks stable and protected by roots; water color is clear to tea-colored; no barriers to fish movement; many fish cover types available; diverse and stable aquatic habitat; no disturbance by livestock or man

**Moderate Quality:** Altered channel evidenced by rip-rap; natural vegetation extends 1/3-1/2 of the active channel width on each side; filtering function or riparian vegetation only moderately compromised; banks moderately unstable; water color is cloudy, submerged objects covered with greenish film; moderate odor; minor barriers to fish movement; fair aquatic habitat; minimum disturbance by livestock or man.

**Low Quality:** Channel is actively down cutting or widening; rip rap and channelization excessive; natural vegetation less than 1/3 of the active channel width on each side; lack of regeneration; filtering function severely compromised; banks unstable (eroding); water color is muddy and turbid; obvious pollutants (algal mats, surface scum, surface sheen); heavy odor; severe barriers to fish movement; little to no aquatic habitat; severe disturbance from livestock or man.

**Notes:**

PERENNIAL STREAM IN VALLEY WITH STABLE, CONFINED CHANNEL; GOOD AQUATIC HABITAT

**Waterbody Sketch** (Include north arrow, centerline, distance from centerline, data point location, survey boundary, and IDs of associated features)

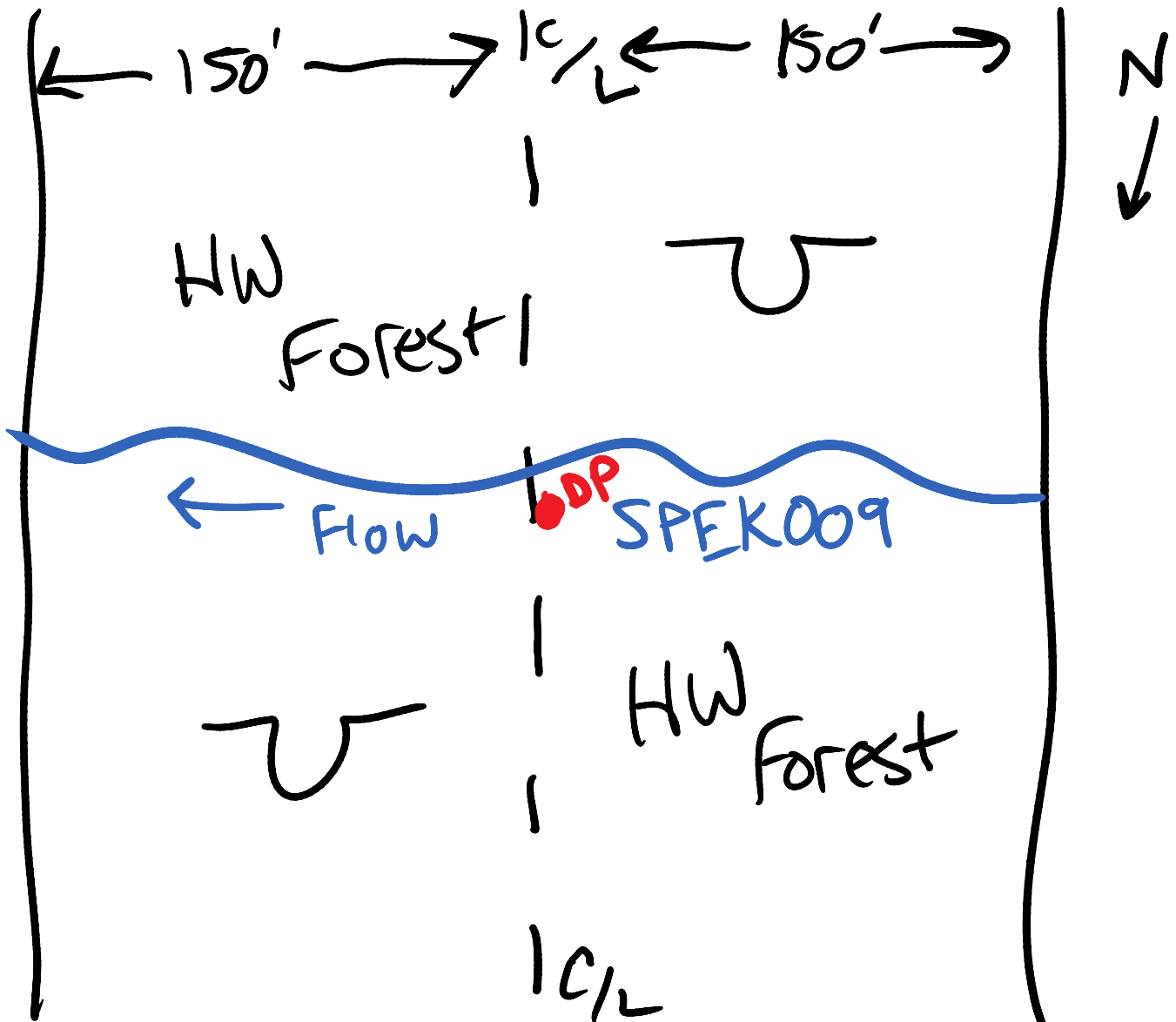



Waterbody point spek009 facing South and upstream



Waterbody point spek009 facing North and downstream



Waterbody point spek009 facing East and across



# Linear Waterbody Data Sheet

Survey Description			
Project Name: Southeast Reliability		Waterbody Name: UNNAMED TRIB TO APPOMATTOX RIVER	
Waterbody ID: SPEK010		Date: 8/2/2014	
State: Virginia	County: Prince Edward	Company: W&C	Crew Member Initials: WM, JD
Photos: 100-0443 TO 0445			
Tract Number(s): 11-026/032		Nearest Milepost: 218	Associated Wetland ID(s): NA
Survey Type: <i>(check one)</i> <input checked="" type="checkbox"/> Centerline <input type="checkbox"/> Re-Route <input type="checkbox"/> Access Road <input type="checkbox"/> Other:			
Physical Attributes			
Stream Classification: <i>(check one)</i> <input type="checkbox"/> Ephemeral <input type="checkbox"/> Intermittent <input checked="" type="checkbox"/> Perennial			
Waterbody Type: <i>(check one)</i> <input type="checkbox"/> River <input checked="" type="checkbox"/> Stream <input type="checkbox"/> Ditch <input type="checkbox"/> Canal <input type="checkbox"/> Other:			
OHWM Width: 6 ft.		OHWM Indicator: <i>(check all that apply)</i>	
Height: 1 ft.		<input checked="" type="checkbox"/> Clear line on bank <input checked="" type="checkbox"/> Shelving <input checked="" type="checkbox"/> Wrested vegetation <input type="checkbox"/> Scouring <input type="checkbox"/> Water staining	
N/A <input type="checkbox"/>		<input type="checkbox"/> Bent, matted, or missing vegetation <input type="checkbox"/> Wrack line <input checked="" type="checkbox"/> Litter and debris <input type="checkbox"/> Abrupt plant community change <input checked="" type="checkbox"/> Soil characteristic change	
Width of Waterbody - Top of Bank to Top of Bank: 10 ft.	Width of Waterbody - Toe of Slope to Toe of Slope: 6 ft.	Width of Waterbody - Water Edge to Water Edge: 3 ft.	Depth of Water: <i>(Approx.)</i> 0.5 ft.
Sinuosity: <i>(check one)</i> <input type="checkbox"/> Straight <input checked="" type="checkbox"/> Meandering		Water velocity: <i>(Approx.)</i> 0.2 fps	Bank height: Right: 3 ft. Left: 5 ft.
N/A <input type="checkbox"/>		Bank slope: Right: 50 degrees Left: 60 degrees	
Qualitative Attributes			
Water Appearance: <i>(check one)</i> <input type="checkbox"/> No water <input checked="" type="checkbox"/> Clear <input type="checkbox"/> Turbid <input type="checkbox"/> Sheen on surface <input type="checkbox"/> Surface scum <input type="checkbox"/> Algal mats <input type="checkbox"/> Other:			
Substrate: <i>(check all that apply)</i>			
% of Substrate:      NA %      NA %      25 %      45 %      20 %      5 %      5 %      _____ %			
Width of Riparian Zone: >100 ft.		Vegetative Layers: <i>(check all that apply)</i>	
N/A <input type="checkbox"/>		<input checked="" type="checkbox"/> Trees: <input checked="" type="checkbox"/> Saplings/Shrubs: <input checked="" type="checkbox"/> Herbs	
		Avg. DBH of Dominants: <i>(approx.)</i> 8 in.      3 in.	
Dominant Bank Vegetation <i>(list)</i> : CEDAR, VIRGINIA PINE, BEECH, BOEHMERIA, DEER TONGUE, LADY FERN, ELEPHANTS FOOT, MICROSTEGIUM			
Aquatic Habitats (ex: submerged or emerged aquatic vegetation, overhanging banks/roots, leaf packs, large submerged wood, riffles, deep pools): COBBLE-GRAVEL, UNDERCUT BANKS, RIFFLE/POOLS, LWD, OVERHANGING VEG			
Aquatic Organisms Observed <i>(list)</i> : EPT, FISH, FROGS			
T&E Species Observed <i>(list)</i> : NA			
Disturbances (ex: livestock access, manure in waterbody, waste discharge pipes): FORD CROSSING AT PIPELINE CENTERLINE; FARMING NEAR STREAM			
Tributary is: <i>(check one)</i> <input checked="" type="checkbox"/> Natural <input type="checkbox"/> Artificial, man-made <input checked="" type="checkbox"/> Manipulated			
Stream Quality <sup>3</sup> : <i>(check one)</i> <input type="checkbox"/> High <input checked="" type="checkbox"/> Moderate <input type="checkbox"/> Low			

Waterbody ID:

SPEK010

<sup>a</sup> **High Quality:** Natural channel, natural vegetation extends at least one or two active channel widths on each side; banks stable and protected by roots; water color is clear to tea-colored; no barriers to fish movement; many fish cover types available; diverse and stable aquatic habitat; no disturbance by livestock or man

**Moderate Quality:** Altered channel evidenced by rip-rap; natural vegetation extends 1/3-1/2 of the active channel width on each side; filtering function or riparian vegetation only moderately compromised; banks moderately unstable; water color is cloudy, submerged objects covered with greenish film; moderate odor; minor barriers to fish movement; fair aquatic habitat; minimum disturbance by livestock or man.

**Low Quality:** Channel is actively down cutting or widening; rip rap and channelization excessive; natural vegetation less than 1/3 of the active channel width on each side; lack of regeneration; filtering function severely compromised; banks unstable (eroding); water color is muddy and turbid; obvious pollutants (algal mats, surface scum, surface sheen); heavy odor; severe barriers to fish movement; little to no aquatic habitat; severe disturbance from livestock or man.

**Notes:**

PERENNIAL STREAM IN YOUNG MIXED PINE-HW FOREST; GOOD AQUATIC HABITAT

**Waterbody Sketch** (Include north arrow, centerline, distance from centerline, data point location, survey boundary, and IDs of associated features)

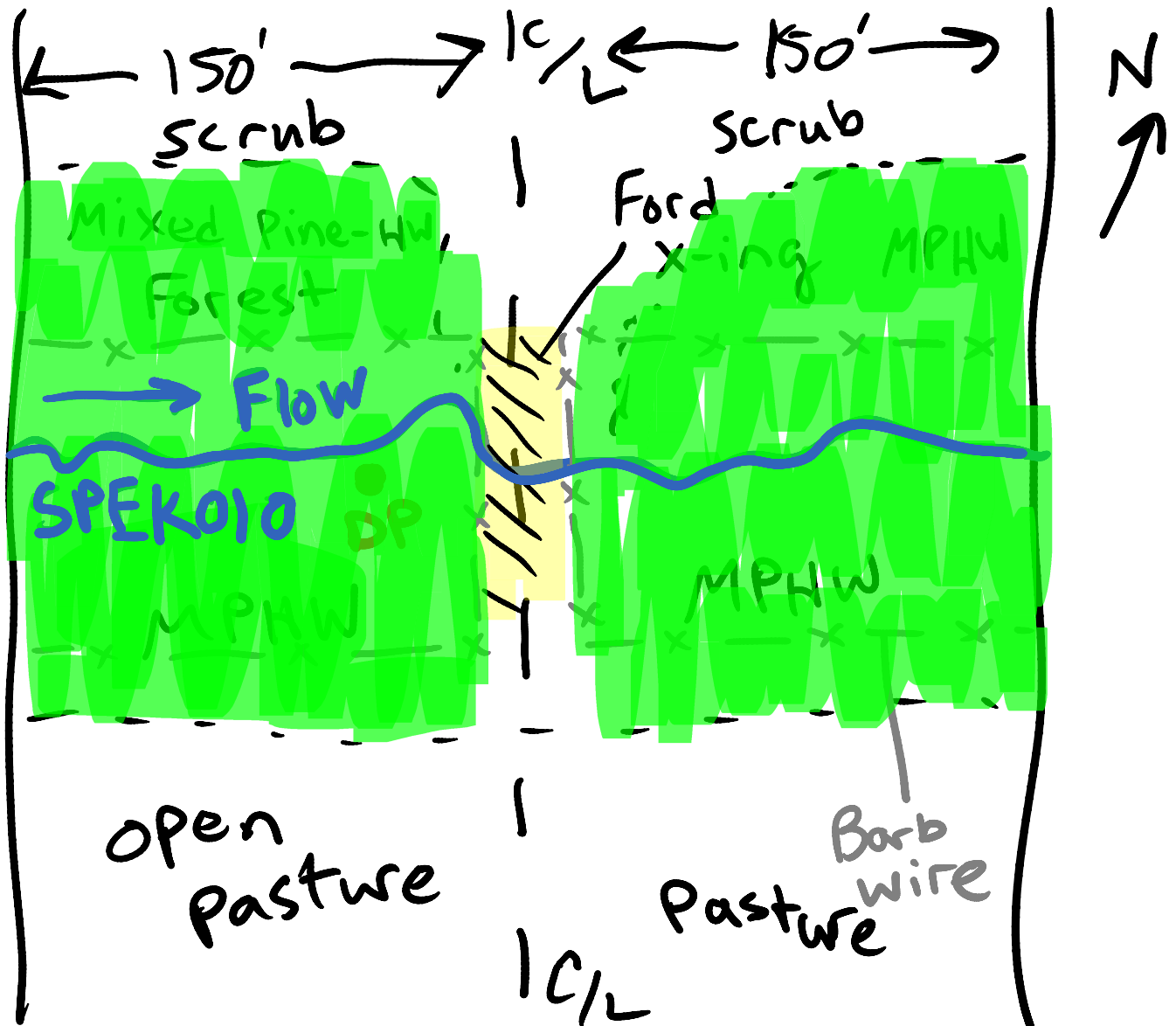



Waterbody point spek010 facing South and upstream



Waterbody point spek010 facing North and downstream



Waterbody point spek010 facing West and across

# Linear Waterbody Data Sheet

Survey Description			
Project Name: Southeast Reliability		Waterbody Name: UNNAMED TRIB TO APPOMATTOX RIVER	
Waterbody ID: SPEK011		Date: 8/2/2014	
State: Virginia	County: Prince Edward	Company: W&C	Crew Member Initials: WM, JD
Photos: 100-0446 TO 0448			
Tract Number(s): 11-035		Nearest Milepost: 218	Associated Wetland ID(s): NA
Survey Type: <i>(check one)</i> <input checked="" type="checkbox"/> Centerline <input type="checkbox"/> Re-Route <input type="checkbox"/> Access Road <input type="checkbox"/> Other:			
Physical Attributes			
Stream Classification: <i>(check one)</i> <input type="checkbox"/> Ephemeral <input checked="" type="checkbox"/> Intermittent <input type="checkbox"/> Perennial			
Waterbody Type: <i>(check one)</i> <input type="checkbox"/> River <input checked="" type="checkbox"/> Stream <input type="checkbox"/> Ditch <input type="checkbox"/> Canal <input type="checkbox"/> Other:			
OHWM Width: 4 ft.		OHWM Indicator: <i>(check all that apply)</i>	
Height: 1 ft.		<input checked="" type="checkbox"/> Clear line on bank <input checked="" type="checkbox"/> Shelving <input checked="" type="checkbox"/> Wrested vegetation <input checked="" type="checkbox"/> Scouring <input checked="" type="checkbox"/> Water staining	
N/A <input type="checkbox"/>		<input type="checkbox"/> Bent, matted, or missing vegetation <input type="checkbox"/> Wrack line <input checked="" type="checkbox"/> Litter and debris <input type="checkbox"/> Abrupt plant community change <input checked="" type="checkbox"/> Soil characteristic change	
Width of Waterbody - Top of Bank to Top of Bank: 12 ft.	Width of Waterbody - Toe of Slope to Toe of Slope: 4 ft.	Width of Waterbody - Water Edge to Water Edge: 1 ft.	Depth of Water: <i>(Approx.)</i> 0.1 ft.
Sinuosity: <i>(check one)</i> <input type="checkbox"/> Straight <input checked="" type="checkbox"/> Meandering		Water velocity: <i>(Approx.)</i> 0.01 fps	Bank height Right: 6 ft. Left: 5 ft.
N/A <input type="checkbox"/>		N/A <input type="checkbox"/>	Bank slope Right: 70 degrees Left: 60 degrees
Qualitative Attributes			
Water Appearance: <i>(check one)</i> <input type="checkbox"/> No water <input checked="" type="checkbox"/> Clear <input type="checkbox"/> Turbid <input type="checkbox"/> Sheen on surface <input type="checkbox"/> Surface scum <input type="checkbox"/> Algal mats <input type="checkbox"/> Other:			
Substrate: <i>(check all that apply)</i>			
% of Substrate:      NA %      NA %      NA %      NA %      20 %      75 %      5 %      _____ %			
Width of Riparian Zone: >100 ft.		Vegetative Layers: <i>(check all that apply)</i>	
N/A <input type="checkbox"/>		<input checked="" type="checkbox"/> Trees: <input checked="" type="checkbox"/> Saplings/Shrubs: <input checked="" type="checkbox"/> Herbs	
Avg. DBH of Dominants: <i>(approx.)</i>		8 in.      1 in.	
Dominant Bank Vegetation <i>(list)</i> : CEDAR, WINGED ELM, TULIP POPLAR, MULTIFLORA ROSE, FRAGARIA, ASPLENUM			
Aquatic Habitats (ex: submerged or emerged aquatic vegetation, overhanging banks/roots, leaf packs, large submerged wood, riffles, deep pools): LWD, OVERHANGING VEG			
Aquatic Organisms Observed <i>(list)</i> : NA			
T&E Species Observed <i>(list)</i> : NA			
Disturbances (ex: livestock access, manure in waterbody, waste discharge pipes): LIVESTOCK INTRUSION; FARMING NEAR STREAM			
Tributary is: <i>(check one)</i> <input checked="" type="checkbox"/> Natural <input type="checkbox"/> Artificial, man-made <input type="checkbox"/> Manipulated			
Stream Quality <sup>3</sup> : <i>(check one)</i> <input type="checkbox"/> High <input type="checkbox"/> Moderate <input checked="" type="checkbox"/> Low			

Waterbody ID:

SPEK011

<sup>a</sup> **High Quality:** Natural channel, natural vegetation extends at least one or two active channel widths on each side; banks stable and protected by roots; water color is clear to tea-colored; no barriers to fish movement; many fish cover types available; diverse and stable aquatic habitat; no disturbance by livestock or man

**Moderate Quality:** Altered channel evidenced by rip-rap; natural vegetation extends 1/3-1/2 of the active channel width on each side; filtering function or riparian vegetation only moderately compromised; banks moderately unstable; water color is cloudy, submerged objects covered with greenish film; moderate odor; minor barriers to fish movement; fair aquatic habitat; minimum disturbance by livestock or man.

**Low Quality:** Channel is actively down cutting or widening; rip rap and channelization excessive; natural vegetation less than 1/3 of the active channel width on each side; lack of regeneration; filtering function severely compromised; banks unstable (eroding); water color is muddy and turbid; obvious pollutants (algal mats, surface scum, surface sheen); heavy odor; severe barriers to fish movement; little to no aquatic habitat; severe disturbance from livestock or man.

**Notes:**

INTERMITTENT STREAM WITH SIGNIFICANT DISTURBANCE; POOR AQUATIC HABITAT

**Waterbody Sketch** (Include north arrow, centerline, distance from centerline, data point location, survey boundary, and IDs of associated features)

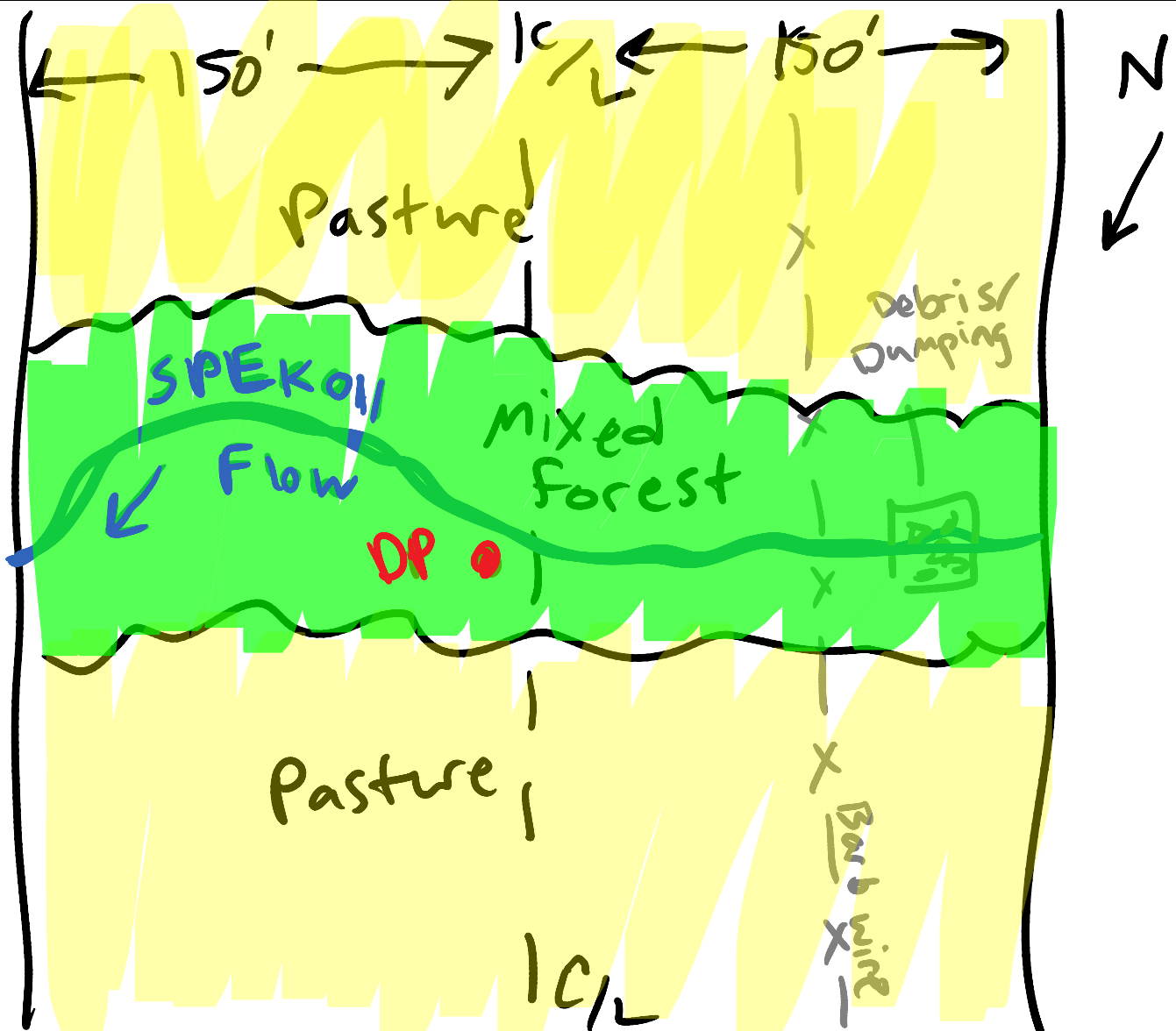



Waterbody point spek011 facing South and upstream



Waterbody point spek011 facing North and downstream



Waterbody point spek011 facing East and across



# Linear Waterbody Data Sheet

Survey Description				
Project Name: Southeast Reliability		Waterbody Name: UNNAMED TRIB TO APPOMATTOX RIVER		Waterbody ID: SPEK012
State: Virginia		County: Prince Edward	Company: W&C	Date: 8/4/2014
Tract Number(s): 11-035/11-036		Nearest Milepost: 218		Photos: 100-0466 TO 0468
Associated Wetland ID(s): Wpek002				
Survey Type: <i>(check one)</i> <input checked="" type="checkbox"/> Centerline <input type="checkbox"/> Re-Route <input type="checkbox"/> Access Road <input type="checkbox"/> Other:				
Physical Attributes				
Stream Classification: <i>(check one)</i> <input type="checkbox"/> Ephemeral <input checked="" type="checkbox"/> Intermittent <input type="checkbox"/> Perennial				
Waterbody Type: <i>(check one)</i> <input type="checkbox"/> River <input checked="" type="checkbox"/> Stream <input type="checkbox"/> Ditch <input type="checkbox"/> Canal <input type="checkbox"/> Other:				
OHWM Width: <u>2</u> ft. Height: <u>0.5</u> ft. N/A <input type="checkbox"/>		OHWM Indicator: <i>(check all that apply)</i> <input checked="" type="checkbox"/> Clear line on bank <input checked="" type="checkbox"/> Shelving <input checked="" type="checkbox"/> Wrested vegetation <input checked="" type="checkbox"/> Scouring <input checked="" type="checkbox"/> Water staining <input checked="" type="checkbox"/> Bent, matted, or missing vegetation <input type="checkbox"/> Wrack line <input checked="" type="checkbox"/> Litter and debris <input type="checkbox"/> Abrupt plant community change <input checked="" type="checkbox"/> Soil characteristic change		
Width of Waterbody - Top of Bank to Top of Bank: <u>8</u> ft.		Width of Waterbody - Toe of Slope to Toe of Slope: <u>2</u> ft.		Depth of Water: <i>(Approx.)</i> N/A <input type="checkbox"/> <u>0.1</u> ft.
Sinuosity: <i>(check one)</i> <input type="checkbox"/> Straight <input checked="" type="checkbox"/> Meandering		Water velocity: <i>(Approx.)</i> <u>0.01</u> fps N/A <input type="checkbox"/>		Bank height Right: <u>3</u> ft. Left: <u>4</u> ft.
Bank slope Right: <u>30</u> degrees Left: <u>45</u> degrees				
Qualitative Attributes				
Water Appearance: <i>(check one)</i> <input type="checkbox"/> No water <input checked="" type="checkbox"/> Clear <input type="checkbox"/> Turbid <input type="checkbox"/> Sheen on surface <input type="checkbox"/> Surface scum <input checked="" type="checkbox"/> Algal mats <input type="checkbox"/> Other:				
Substrate: <i>(check all that apply)</i> <input checked="" type="checkbox"/> Bedrock <input type="checkbox"/> Boulder <input type="checkbox"/> Cobble <input checked="" type="checkbox"/> Gravel <input checked="" type="checkbox"/> Sand <input checked="" type="checkbox"/> Silt/ clay <input checked="" type="checkbox"/> Organic <input type="checkbox"/> Other: % of Substrate: <u>2</u> % <u>NA</u> % <u>NA</u> % <u>18</u> % <u>20</u> % <u>55</u> % <u>5</u> %    _____ %				
Width of Riparian Zone: <u>&gt;100</u> ft. N/A <input type="checkbox"/>		Vegetative Layers: <i>(check all that apply)</i> <input checked="" type="checkbox"/> Trees: <input checked="" type="checkbox"/> Saplings/Shrubs: <input checked="" type="checkbox"/> Herbs Avg. DBH of Dominants: <i>(approx.)</i> <u>6</u> in. <u>1</u> in.		
Dominant Bank Vegetation <i>(list)</i> : CEDAR, WINGED ELM, HACKBERRY, MULTIFLORA ROSE, DOGFENNEL, ASPLENium				
Aquatic Habitats (ex: submerged or emerged aquatic vegetation, overhanging banks/roots, leaf packs, large submerged wood, riffles, deep pools): LWD, OVERHANGING VEG				
Aquatic Organisms Observed <i>(list)</i> : NA				
T&E Species Observed <i>(list)</i> : NA				
Disturbances (ex: livestock access, manure in waterbody, waste discharge pipes): LIVESTOCK INTRUSION; FARMING NEAR STREAM				
Tributary is: <i>(check one)</i> <input checked="" type="checkbox"/> Natural <input type="checkbox"/> Artificial, man-made <input type="checkbox"/> Manipulated				
Stream Quality <sup>a</sup> : <i>(check one)</i> <input type="checkbox"/> High <input type="checkbox"/> Moderate <input checked="" type="checkbox"/> Low				

Waterbody ID:  
SPEK012

<sup>a</sup> **High Quality:** Natural channel, natural vegetation extends at least one or two active channel widths on each side; banks stable and protected by roots; water color is clear to tea-colored; no barriers to fish movement; many fish cover types available; diverse and stable aquatic habitat; no disturbance by livestock or man

**Moderate Quality:** Altered channel evidenced by rip-rap; natural vegetation extends 1/3-1/2 of the active channel width on each side; filtering function or riparian vegetation only moderately compromised; banks moderately unstable; water color is cloudy, submerged objects covered with greenish film; moderate odor; minor barriers to fish movement; fair aquatic habitat; minimum disturbance by livestock or man.

**Low Quality:** Channel is actively down cutting or widening; rip rap and channelization excessive; natural vegetation less than 1/3 of the active channel width on each side; lack of regeneration; filtering function severely compromised; banks unstable (eroding); water color is muddy and turbid; obvious pollutants (algal mats, surface scum, surface sheen); heavy odor; severe barriers to fish movement; little to no aquatic habitat; severe disturbance from livestock or man.

**Notes:**

INTERMITTENT STREAM WITH SIGNIFICANT DISTURBANCE; POOR AQUATIC HABITAT

**Waterbody Sketch** (Include north arrow, centerline, distance from centerline, data point location, survey boundary, and IDs of associated features)

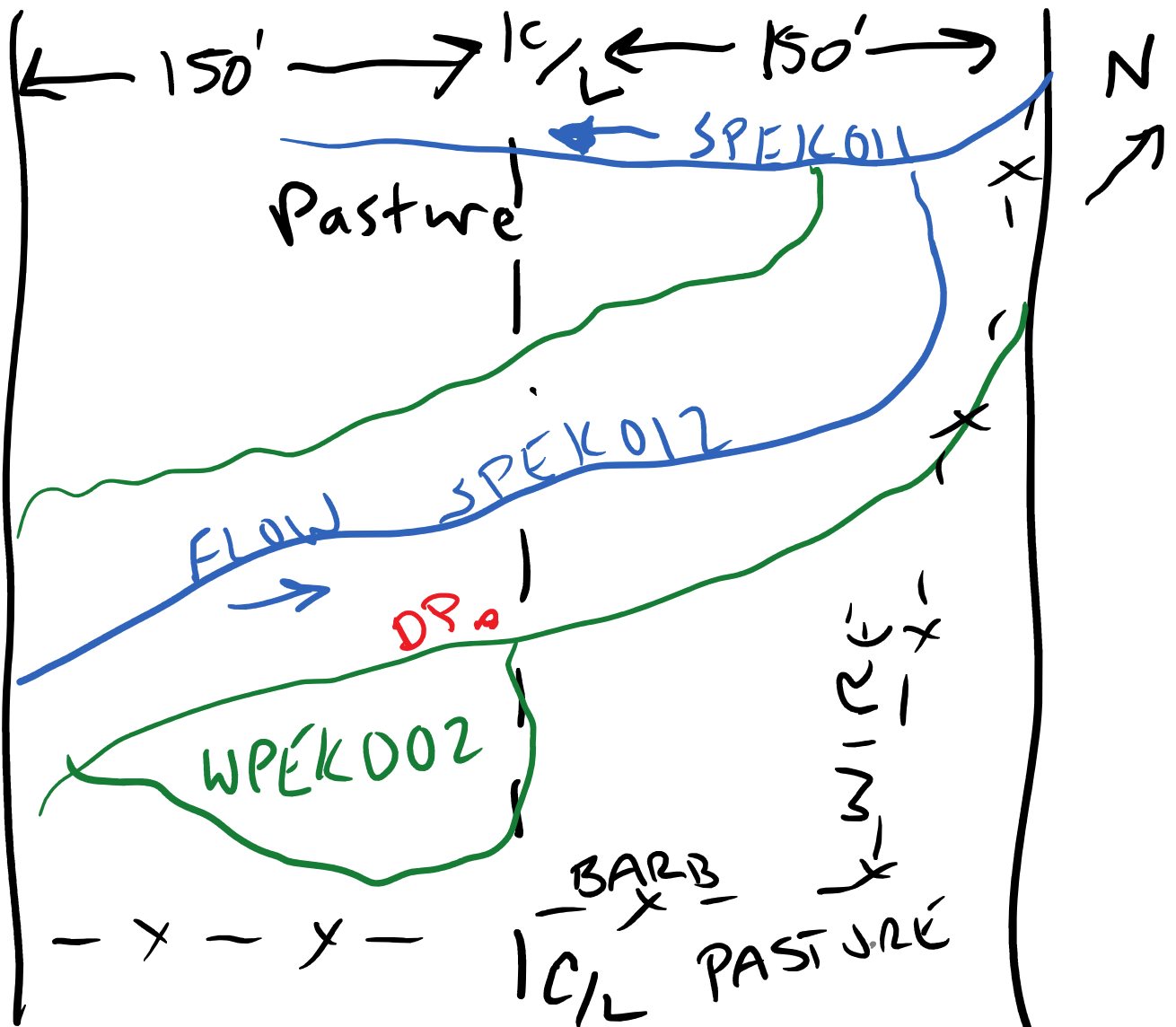



Waterbody point spek012 facing North and  
upstream



Waterbody point spek012 facing South and  
downstream



Waterbody point spek012 facing West and across

# Linear Waterbody Data Sheet

Survey Description			
Project Name: Atlantic Coast Pipeline		Waterbody Name: Little Saylers Creek	
Waterbody ID: spea401		Date: 6/28/2016	
State: Virginia	County: Prince Edward	Company: NRG - ERM	Crew Member Initials: GB, KO
Photos: 3 photos			
Tract Number(s): 11-049		Nearest Milepost: 223.2	Associated Wetland ID(s): wpea005
Survey Type: <small>(check one)</small> <input checked="" type="checkbox"/> Centerline <input type="checkbox"/> Re-Route <input type="checkbox"/> Access Road <input type="checkbox"/> Other:			
Physical Attributes <input checked="" type="checkbox"/>			
Stream Classification: <small>(check one)</small> <input type="checkbox"/> Ephemeral <input type="checkbox"/> Intermittent <input checked="" type="checkbox"/> Perennial			
Waterbody Type: <small>(check one)</small> <input type="checkbox"/> River <input checked="" type="checkbox"/> Stream <input type="checkbox"/> Ditch <input type="checkbox"/> Canal <input type="checkbox"/> Other:			
OHWM Width: _____ ft.  Height: _____ ft. N/A <input type="checkbox"/>		OHWM Indicator: <small>(check all that apply)</small> <input checked="" type="checkbox"/> Clear line on bank <input type="checkbox"/> Shelving <input type="checkbox"/> Wrested vegetation <input checked="" type="checkbox"/> Scouring <input type="checkbox"/> Water staining  <input type="checkbox"/> Bent, matted, or missing vegetation <input checked="" type="checkbox"/> Wrack line <input type="checkbox"/> Litter and debris <input type="checkbox"/> Abrupt plant community change <input type="checkbox"/> Soil characteristic change	
Width of Waterbody - Top of Bank to Top of Bank: _____ ft.	Width of Waterbody - Toe of Slope to Toe of Slope: _____ ft.	Width of Waterbody - Water Edge to Water Edge: N/A <input type="checkbox"/> _____ ft.	Depth of Water: <small>(Approx.)</small> _____ ft.
Sinuosity: <small>(check one)</small> <input type="checkbox"/> Straight <input checked="" type="checkbox"/> Meandering	Water velocity: <small>(Approx.)</small> _____ fps N/A <input type="checkbox"/>	Bank height Right: _____ ft. Left: _____ ft.	Bank slope Right: _____ degrees Left: _____ degrees
Qualitative Attributes			
Water Appearance: <small>(check one)</small> <input type="checkbox"/> No water <input checked="" type="checkbox"/> Clear <input type="checkbox"/> Turbid <input type="checkbox"/> Sheen on surface <input type="checkbox"/> Surface scum <input type="checkbox"/> Algal mats <input type="checkbox"/> Other:			
Substrate: <small>(check all that apply)</small> <input type="checkbox"/> Bedrock <input type="checkbox"/> Boulder <input type="checkbox"/> Cobble <input checked="" type="checkbox"/> Gravel <input checked="" type="checkbox"/> Sand <input checked="" type="checkbox"/> Silt/ clay <input checked="" type="checkbox"/> Organic <input type="checkbox"/> Other: % of Substrate:      _____%      _____%      _____% <u>5</u> % <u>75</u> % <u>15</u> % <u>5</u> %      _____%			
Width of Riparian Zone: _____ ft. N/A <input type="checkbox"/>	Vegetative Layers: <small>(check all that apply)</small> <input checked="" type="checkbox"/> Trees: <input checked="" type="checkbox"/> Saplings/Shrubs: <input checked="" type="checkbox"/> Herbs Avg. DBH of Dominants: <small>(approx.)</small> _____ in.      _____ in.		
Dominant Bank Vegetation <small>(list)</small> : Red maple, sycamore, river birch, box elder, red elm, mulberry, pawpaw, spicebush, ironwood, walnut, grape, greenbrier, Wingate, deer-tongue grass, wild rye, Japanese stilt grass			
Aquatic Habitats <small>(ex: submerged or emerged aquatic vegetation, overhanging banks/roots, leaf packs, large submerged wood, riffles, deep pools)</small> : Pools, coarse woody debris, wrack piles, leaf packs, overhanging roots and banks			
Aquatic Organisms Observed <small>(list)</small> : Water striders, riffle beetles, fish, frogs			
T&E Species Observed <small>(list)</small> : none			
Disturbances <small>(ex: livestock access, manure in waterbody, waste discharge pipes)</small> : None apparent			
Tributary is: <small>(check one)</small> <input checked="" type="checkbox"/> Natural <input type="checkbox"/> Artificial, man-made <input type="checkbox"/> Manipulated			
Stream Quality <sup>3</sup> : <small>(check one)</small> <input checked="" type="checkbox"/> High <input type="checkbox"/> Moderate <input type="checkbox"/> Low			

Waterbody ID:

spea401

<sup>a</sup> **High Quality:** Natural channel, natural vegetation extends at least one or two active channel widths on each side; banks stable and protected by roots; water color is clear to tea-colored; no barriers to fish movement; many fish cover types available; diverse and stable aquatic habitat; no disturbance by livestock or man.

**Moderate Quality:** Altered channel evidenced by rip-rap; natural vegetation extends 1/3-1/2 of the active channel width on each side; filtering function or riparian vegetation only moderately compromised; banks moderately unstable; water color is cloudy, submerged objects covered with greenish film; moderate odor; minor barriers to fish movement; fair aquatic habitat; minimum disturbance by livestock or man.

**Low Quality:** Channel is actively down cutting or widening; rip rap and channelization excessive; natural vegetation less than 1/3 of the active channel width on each side; lack of regeneration; filtering function severely compromised; banks unstable (eroding); water color is muddy and turbid; obvious pollutants (algal mats, surface scum, surface sheen); heavy odor; severe barriers to fish movement; little to no aquatic habitat; severe disturbance from livestock or man.

**Notes:**

Stream continues out of corridor in both directions; flows through wetland wpea005. Area is mature second growth mixed bottomland hardwood forest.

**Waterbody Sketch** (Include north arrow, centerline, distance from centerline, data point location, survey boundary, and IDs of associated features)

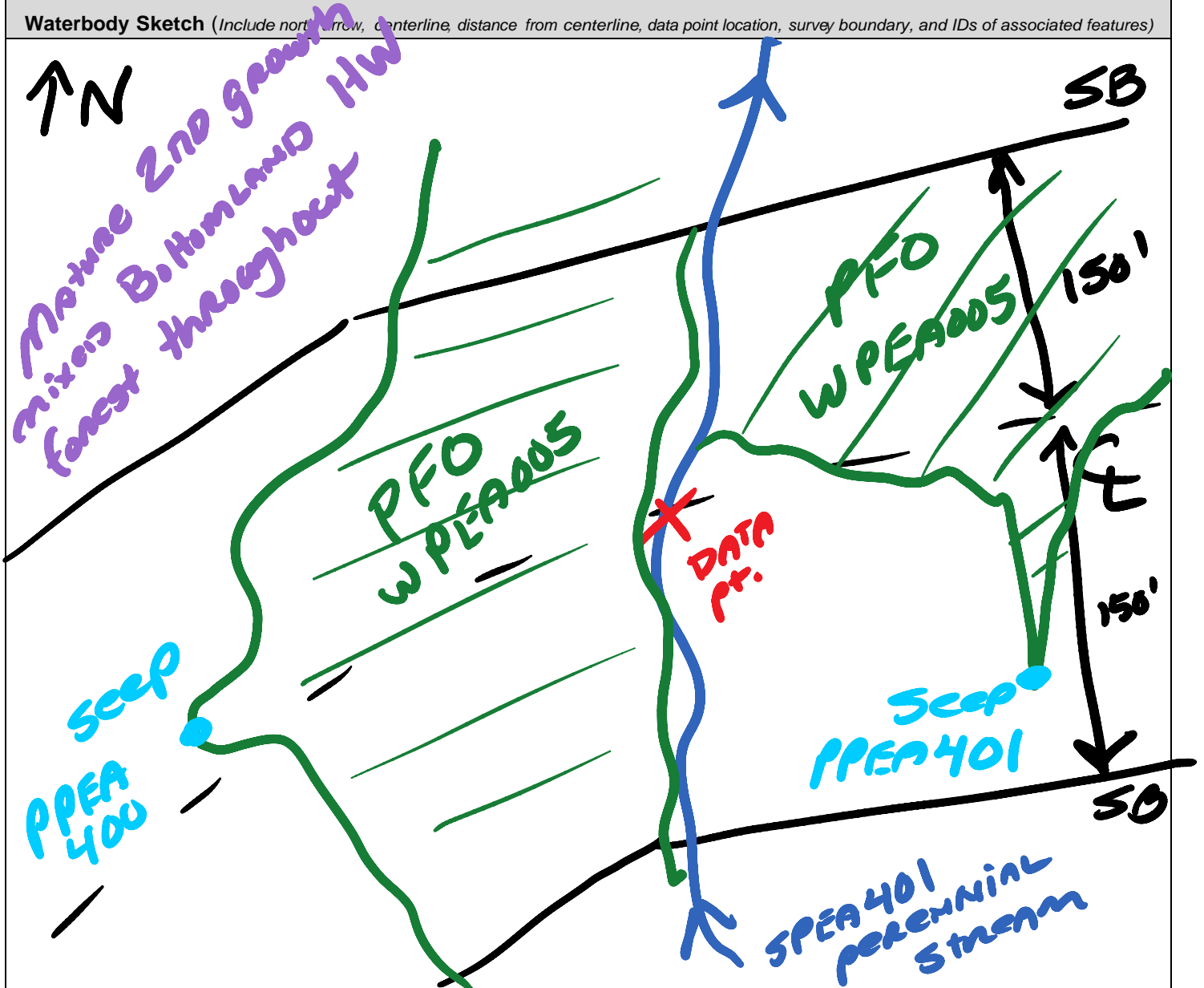



Waterbody SPEA401 facing northeast upstream



Waterbody SPEA401 facing southwest downstream



Waterbody SPEA401 facing northwest across



# Linear Waterbody Data Sheet

Survey Description			
Project Name: Atlantic Coast Pipeline		Waterbody Name: UNT to Little Sayers Creek	
Waterbody ID: spea006		Date: 10/20/2014	
State: Virginia	County: Prince Edward	Company: NRG	Crew Member Initials: GB, TP
Photos: 3 photos			
Tract Number(s): 11-051		Nearest Milepost: 220.55	Associated Wetland ID(s): none
Survey Type: <i>(check one)</i> <input checked="" type="checkbox"/> Centerline <input type="checkbox"/> Re-Route <input type="checkbox"/> Access Road <input type="checkbox"/> Other:			
Physical Attributes			
Stream Classification: <i>(check one)</i> <input type="checkbox"/> Ephemeral <input checked="" type="checkbox"/> Intermittent <input type="checkbox"/> Perennial			
Waterbody Type: <i>(check one)</i> <input type="checkbox"/> River <input checked="" type="checkbox"/> Stream <input type="checkbox"/> Ditch <input type="checkbox"/> Canal <input type="checkbox"/> Other:			
OHWM Width: 4.0 ft.		OHWM Indicator: <i>(check all that apply)</i>	
Height: 0.5 ft.		<input checked="" type="checkbox"/> Clear line on bank <input checked="" type="checkbox"/> Shelving <input type="checkbox"/> Wrested vegetation <input checked="" type="checkbox"/> Scouring <input type="checkbox"/> Water staining	
N/A <input type="checkbox"/>		<input type="checkbox"/> Bent, matted, or missing vegetation <input type="checkbox"/> Wrack line <input checked="" type="checkbox"/> Litter and debris <input type="checkbox"/> Abrupt plant community change <input type="checkbox"/> Soil characteristic change	
Width of Waterbody - Top of Bank to Top of Bank: 10.0 ft.	Width of Waterbody - Toe of Slope to Toe of Slope: 3.0 ft.	Width of Waterbody - Water Edge to Water Edge: 3.0 ft.	Depth of Water: <i>(Approx.)</i> 0.25 ft.
N/A <input type="checkbox"/>	N/A <input type="checkbox"/>	N/A <input type="checkbox"/>	N/A <input type="checkbox"/>
Sinuosity: <i>(check one)</i> <input type="checkbox"/> Straight <input checked="" type="checkbox"/> Meandering	Water velocity: <i>(Approx.)</i> 0.5 fps	Bank height Right: 5.0 ft. Left: 4.5 ft.	Bank slope Right: 60 degrees Left: 70 degrees
N/A <input type="checkbox"/>	N/A <input type="checkbox"/>		
Qualitative Attributes			
Water Appearance: <i>(check one)</i> <input type="checkbox"/> No water <input checked="" type="checkbox"/> Clear <input type="checkbox"/> Turbid <input type="checkbox"/> Sheen on surface <input type="checkbox"/> Surface scum <input type="checkbox"/> Algal mats <input type="checkbox"/> Other:			
Substrate: <i>(check all that apply)</i>			
<input checked="" type="checkbox"/> Bedrock <input checked="" type="checkbox"/> Boulder <input checked="" type="checkbox"/> Cobble <input checked="" type="checkbox"/> Gravel <input checked="" type="checkbox"/> Sand <input checked="" type="checkbox"/> Silt/ clay <input type="checkbox"/> Organic <input type="checkbox"/> Other:			
% of Substrate:      15 %      10 %      20 %      10 %      30 %      15 %      _____ %      _____ %			
Width of Riparian Zone: _____ ft.	Vegetative Layers: <i>(check all that apply)</i>		
N/A <input checked="" type="checkbox"/>	<input checked="" type="checkbox"/> Trees: <input checked="" type="checkbox"/> Saplings/Shrubs: <input checked="" type="checkbox"/> Herbs		
	Avg. DBH of Dominants: <i>(approx.)</i> 8.0 in.      2.0 in.		
Dominant Bank Vegetation <i>(list)</i> : Yellow poplar, beech, hickory, sweetgum, flowering dogwood, pawpaw, azalea, Japanese honeysuckle, Christmas fern, wood rush, violet, foamflower, greenbrier			
Aquatic Habitats <i>(ex: submerged or emerged aquatic vegetation, overhanging banks/roots, leaf packs, large submerged wood, riffles, deep pools)</i> : Small pools, overhanging roots and banks, leaf packs			
Aquatic Organisms Observed <i>(list)</i> : Water striders, caddisfly larvae			
T&E Species Observed <i>(list)</i> : none			
Disturbances <i>(ex: livestock access, manure in waterbody, waste discharge pipes)</i> : Surrounding clear cut with minimal buffer			
Tributary is: <i>(check one)</i> <input checked="" type="checkbox"/> Natural <input type="checkbox"/> Artificial, man-made <input type="checkbox"/> Manipulated			
Stream Quality <sup>a</sup> : <i>(check one)</i> <input type="checkbox"/> High <input checked="" type="checkbox"/> Moderate <input type="checkbox"/> Low			

Waterbody ID:

spea006

<sup>a</sup> **High Quality:** Natural channel, natural vegetation extends at least one or two active channel widths on each side; banks stable and protected by roots; water color is clear to tea-colored; no barriers to fish movement; many fish cover types available; diverse and stable aquatic habitat; no disturbance by livestock or man.

**Moderate Quality:** Altered channel evidenced by rip-rap; natural vegetation extends 1/3-1/2 of the active channel width on each side; filtering function or riparian vegetation only moderately compromised; banks moderately unstable; water color is cloudy, submerged objects covered with greenish film; moderate odor; minor barriers to fish movement; fair aquatic habitat; minimum disturbance by livestock or man.

**Low Quality:** Channel is actively down cutting or widening; rip rap and channelization excessive; natural vegetation less than 1/3 of the active channel width on each side; lack of regeneration; filtering function severely compromised; banks unstable (eroding); water color is muddy and turbid; obvious pollutants (algal mats, surface scum, surface sheen); heavy odor; severe barriers to fish movement; little to no aquatic habitat; severe disturbance from livestock or man.

**Notes:**

Stream continues out of corridor in both directions, flows through mixed hardwoods that were clear cut about three years ago, minimal buffer was left along stream course,

**Waterbody Sketch** (Include north arrow, centerline, distance from centerline, data point location, survey boundary, and IDs of associated features)

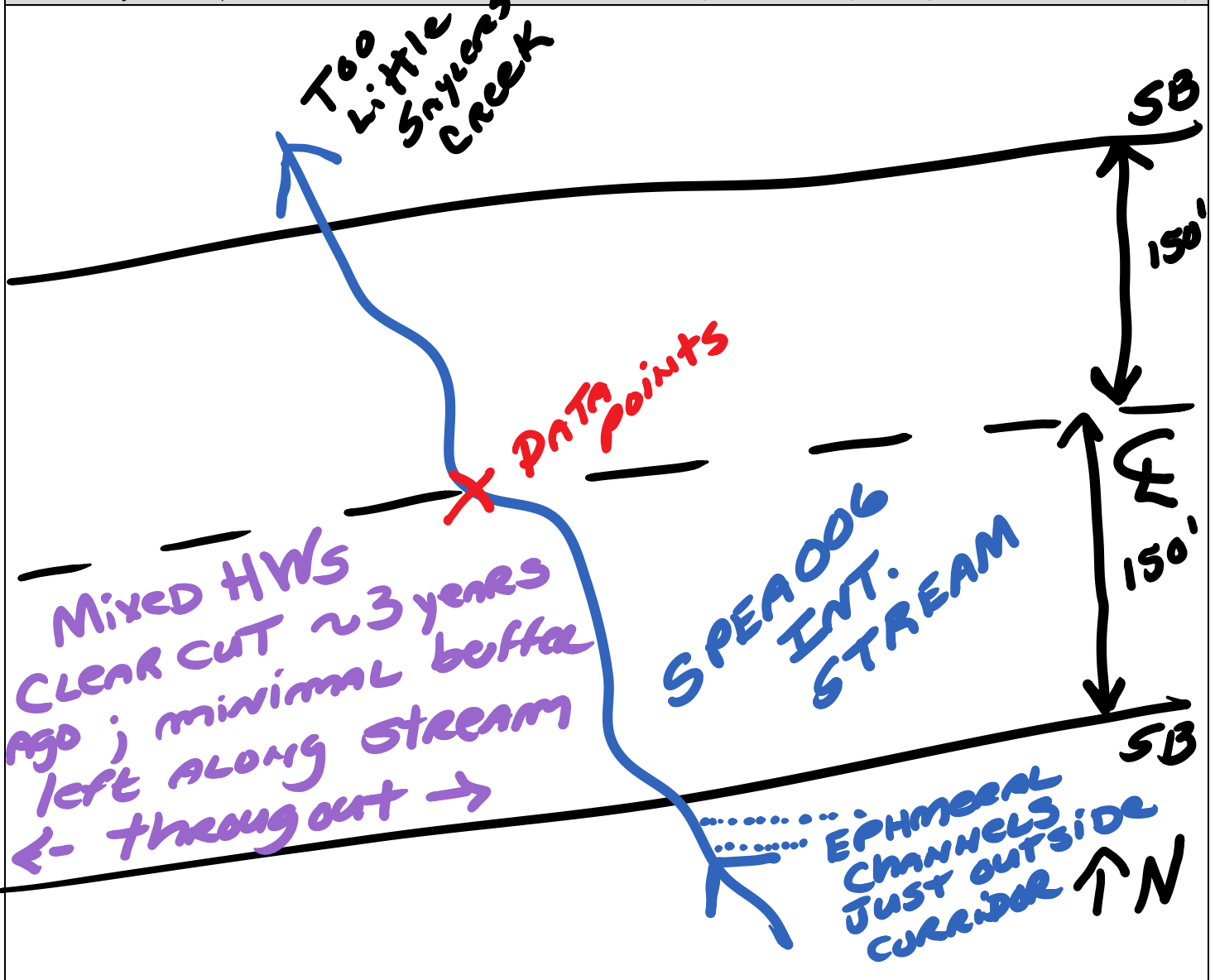



SPEA006 facing south upstream



SPEA006 facing north downstream



SPEA006 facing west across

# Linear Waterbody Data Sheet

Survey Description				
Project Name: Atlantic Coast Pipeline		Waterbody Name: UNT to Little Sayers Creek		Waterbody ID: spea001
Date: 10/17/2014				
State: Virginia	County: Prince Edward	Company: NRG	Crew Member Initials: GB, LE	Photos: 3 photos
Tract Number(s): 11-051; 11-052		Nearest Milepost: 220.9	Associated Wetland ID(s): wpea001	
Survey Type: <i>(check one)</i> <input checked="" type="checkbox"/> Centerline <input type="checkbox"/> Re-Route <input type="checkbox"/> Access Road <input type="checkbox"/> Other:				
Physical Attributes				
Stream Classification: <i>(check one)</i> <input type="checkbox"/> Ephemeral <input checked="" type="checkbox"/> Intermittent <input type="checkbox"/> Perennial				
Waterbody Type: <i>(check one)</i> <input type="checkbox"/> River <input checked="" type="checkbox"/> Stream <input type="checkbox"/> Ditch <input type="checkbox"/> Canal <input type="checkbox"/> Other:				
OHWM Width: 2.0 ft.		OHWM Indicator: <i>(check all that apply)</i>		
Height: 0.50 ft.		<input checked="" type="checkbox"/> Clear line on bank <input type="checkbox"/> Shelving <input type="checkbox"/> Wrested vegetation <input checked="" type="checkbox"/> Scouring <input type="checkbox"/> Water staining		
N/A <input type="checkbox"/>		<input type="checkbox"/> Bent, matted, or missing vegetation <input type="checkbox"/> Wrack line <input checked="" type="checkbox"/> Litter and debris <input type="checkbox"/> Abrupt plant community change <input type="checkbox"/> Soil characteristic change		
Width of Waterbody - Top of Bank to Top of Bank: 7.0 ft.	Width of Waterbody - Toe of Slope to Toe of Slope: 1.0 ft.	Width of Waterbody - Water Edge to Water Edge: 1.25 ft.	Depth of Water: <i>(Approx.)</i> 0.20 ft.	
Sinuosity: <i>(check one)</i> <input type="checkbox"/> Straight <input checked="" type="checkbox"/> Meandering		Water velocity: <i>(Approx.)</i> 0.25 fps	Bank height Right: 4.0 ft. Left: 5.0 ft.	Bank slope Right: 75 degrees Left: 70 degrees
N/A <input type="checkbox"/>		N/A <input type="checkbox"/>		
Qualitative Attributes				
Water Appearance: <i>(check one)</i> <input type="checkbox"/> No water <input checked="" type="checkbox"/> Clear <input type="checkbox"/> Turbid <input type="checkbox"/> Sheen on surface <input type="checkbox"/> Surface scum <input type="checkbox"/> Algal mats <input type="checkbox"/> Other:				
Substrate: <i>(check all that apply)</i>				
% of Substrate:      _____%      _____%      5%      _____%      50%      40%      5%      _____%				
Width of Riparian Zone: _____ ft.	Vegetative Layers: <i>(check all that apply)</i> <input checked="" type="checkbox"/> Trees: <input checked="" type="checkbox"/> Saplings/Shrubs: <input checked="" type="checkbox"/> Herbs			
N/A <input checked="" type="checkbox"/>	Avg. DBH of Dominants: <i>(approx.)</i> 9.0 in.      1.0 in.			
Dominant Bank Vegetation <i>(list)</i> : Beech, hickory, loblolly pine, red oak, black gum, spicebush, pawpaw, ironwood, blueberry, Christmas fern				
Aquatic Habitats (ex: submerged or emerged aquatic vegetation, overhanging banks/roots, leaf packs, large submerged wood, riffles, deep pools): Small pools, leaf packs				
Aquatic Organisms Observed <i>(list)</i> : none				
T&E Species Observed <i>(list)</i> : none				
Disturbances (ex: livestock access, manure in waterbody, waste discharge pipes): Recent clear cut on northeast side				
Tributary is: <i>(check one)</i> <input checked="" type="checkbox"/> Natural <input type="checkbox"/> Artificial, man-made <input type="checkbox"/> Manipulated				
Stream Quality <sup>a</sup> : <i>(check one)</i> <input type="checkbox"/> High <input checked="" type="checkbox"/> Moderate <input type="checkbox"/> Low				

Waterbody ID:

spea001

<sup>a</sup> **High Quality:** Natural channel, natural vegetation extends at least one or two active channel widths on each side; banks stable and protected by roots; water color is clear to tea-colored; no barriers to fish movement; many fish cover types available; diverse and stable aquatic habitat; no disturbance by livestock or man.

**Moderate Quality:** Altered channel evidenced by rip-rap; natural vegetation extends 1/3-1/2 of the active channel width on each side; filtering function or riparian vegetation only moderately compromised; banks moderately unstable; water color is cloudy, submerged objects covered with greenish film; moderate odor; minor barriers to fish movement; fair aquatic habitat; minimum disturbance by livestock or man.

**Low Quality:** Channel is actively down cutting or widening; rip rap and channelization excessive; natural vegetation less than 1/3 of the active channel width on each side; lack of regeneration; filtering function severely compromised; banks unstable (eroding); water color is muddy and turbid; obvious pollutants (algal mats, surface scum, surface sheen); heavy odor; severe barriers to fish movement; little to no aquatic habitat; severe disturbance from livestock or man.

**Notes:**

Begins at head cut within the corridor, downstream continues out; spea002 is a tributary; recent clear cut to NE, mixed hardwoods with pines to the SW. PFO wetland located at confluence of spea001 & spea002.

**Waterbody Sketch** (Include north arrow, centerline, distance from centerline, data point location, survey boundary, and IDs of associated features)

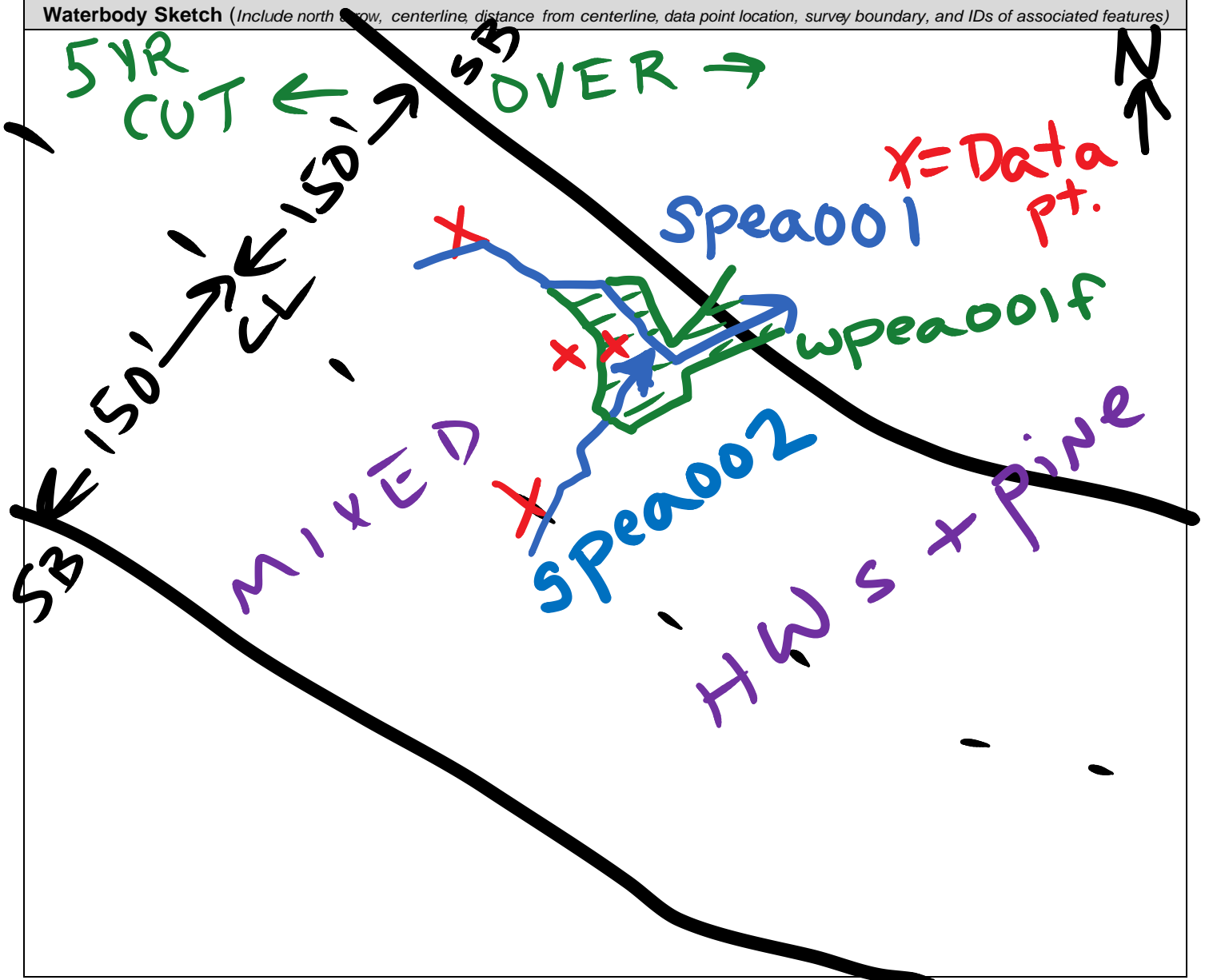



Waterbody SPEA001 facing west upstream



Waterbody SPEA001 facing east downstream



Waterbody SPEA001 facing north across



# Linear Waterbody Data Sheet

Survey Description				
Project Name: Atlantic Coast Pipeline		Waterbody Name: UNT to Little Sayers Creek		Waterbody ID: spea002
Date: 10/17/2014				
State: Virginia	County: Prince Edward	Company: NRG	Crew Member Initials: GB, LE	Photos: 3 photos
Tract Number(s): 11-052		Nearest Milepost: 220.9		Associated Wetland ID(s): wpea001
Survey Type: <i>(check one)</i> <input checked="" type="checkbox"/> Centerline <input type="checkbox"/> Re-Route <input type="checkbox"/> Access Road <input type="checkbox"/> Other:				
Physical Attributes				
Stream Classification: <i>(check one)</i> <input type="checkbox"/> Ephemeral <input checked="" type="checkbox"/> Intermittent <input type="checkbox"/> Perennial				
Waterbody Type: <i>(check one)</i> <input type="checkbox"/> River <input checked="" type="checkbox"/> Stream <input type="checkbox"/> Ditch <input type="checkbox"/> Canal <input type="checkbox"/> Other:				
OHWM Width: 2.0 ft.		OHWM Indicator: <i>(check all that apply)</i> <input checked="" type="checkbox"/> Clear line on bank <input type="checkbox"/> Shelving <input type="checkbox"/> Wrested vegetation <input checked="" type="checkbox"/> Scouring <input type="checkbox"/> Water staining		
OHWM Height: 0.50 ft.		<input type="checkbox"/> Bent, matted, or missing vegetation <input type="checkbox"/> Wrack line <input checked="" type="checkbox"/> Litter and debris <input type="checkbox"/> Abrupt plant community change <input type="checkbox"/> Soil characteristic change		
N/A <input type="checkbox"/>				
Width of Waterbody - Top of Bank to Top of Bank: 10.0 ft.	Width of Waterbody - Toe of Slope to Toe of Slope: 1.0 ft.	Width of Waterbody - Water Edge to Water Edge: 1.0 ft.	Depth of Water: <i>(Approx.)</i> 0.25 ft.	
N/A <input type="checkbox"/>		N/A <input type="checkbox"/>		
Sinuosity: <i>(check one)</i> <input type="checkbox"/> Straight <input checked="" type="checkbox"/> Meandering		Water velocity: <i>(Approx.)</i> 0.25 fps		Bank slope Right: 60 degrees Left: 70 degrees
N/A <input type="checkbox"/>		N/A <input type="checkbox"/>		
Qualitative Attributes				
Water Appearance: <i>(check one)</i> <input type="checkbox"/> No water <input checked="" type="checkbox"/> Clear <input type="checkbox"/> Turbid <input type="checkbox"/> Sheen on surface <input type="checkbox"/> Surface scum <input type="checkbox"/> Algal mats <input type="checkbox"/> Other:				
Substrate: <i>(check all that apply)</i> <input type="checkbox"/> Bedrock <input type="checkbox"/> Boulder <input type="checkbox"/> Cobble <input type="checkbox"/> Gravel <input checked="" type="checkbox"/> Sand <input checked="" type="checkbox"/> Silt/ clay <input checked="" type="checkbox"/> Organic <input type="checkbox"/> Other:				
% of Substrate:      _____%      _____%      _____%      _____%      45%      45%      10%      _____%				
Width of Riparian Zone: _____ ft.		Vegetative Layers: <i>(check all that apply)</i> <input checked="" type="checkbox"/> Trees: <input checked="" type="checkbox"/> Saplings/Shrubs: <input checked="" type="checkbox"/> Herbs		
N/A <input checked="" type="checkbox"/>		Avg. DBH of Dominants: <i>(approx.)</i> 9.0 in.      1.0 in.		
Dominant Bank Vegetation <i>(list)</i> : Beech, hickory, loblolly pine, red oak, black gum, spicebush, pawpaw, ironwood, blueberry, Christmas fern				
Aquatic Habitats (ex: submerged or emerged aquatic vegetation, overhanging banks/roots, leaf packs, large submerged wood, riffles, deep pools): Small pools, leaf packs				
Aquatic Organisms Observed <i>(list)</i> : none				
T&E Species Observed <i>(list)</i> : none				
Disturbances (ex: livestock access, manure in waterbody, waste discharge pipes): Recent clear cut				
Tributary is: <i>(check one)</i> <input checked="" type="checkbox"/> Natural <input type="checkbox"/> Artificial, man-made <input type="checkbox"/> Manipulated				
Stream Quality <sup>a</sup> : <i>(check one)</i> <input type="checkbox"/> High <input checked="" type="checkbox"/> Moderate <input type="checkbox"/> Low				

Waterbody ID:  
spea002

<sup>a</sup> **High Quality:** Natural channel, natural vegetation extends at least one or two active channel widths on each side; banks stable and protected by roots; water color is clear to tea-colored; no barriers to fish movement; many fish cover types available; diverse and stable aquatic habitat; no disturbance by livestock or man.

**Moderate Quality:** Altered channel evidenced by rip-rap; natural vegetation extends 1/3-1/2 of the active channel width on each side; filtering function or riparian vegetation only moderately compromised; banks moderately unstable; water color is cloudy, submerged objects covered with greenish film; moderate odor; minor barriers to fish movement; fair aquatic habitat; minimum disturbance by livestock or man.

**Low Quality:** Channel is actively down cutting or widening; rip rap and channelization excessive; natural vegetation less than 1/3 of the active channel width on each side; lack of regeneration; filtering function severely compromised; banks unstable (eroding); water color is muddy and turbid; obvious pollutants (algal mats, surface scum, surface sheen); heavy odor; severe barriers to fish movement; little to no aquatic habitat; severe disturbance from livestock or man.

**Notes:**

Begins at head cut within the corridor near centerline, downstream flows into spea001; recent clear at confluence, mixed hardwoods with pines upstream. PFO wetland located at confluence of spea001 & spea002.

**Waterbody Sketch** (Include north arrow, centerline, distance from centerline, data point location, survey boundary, and IDs of associated features)

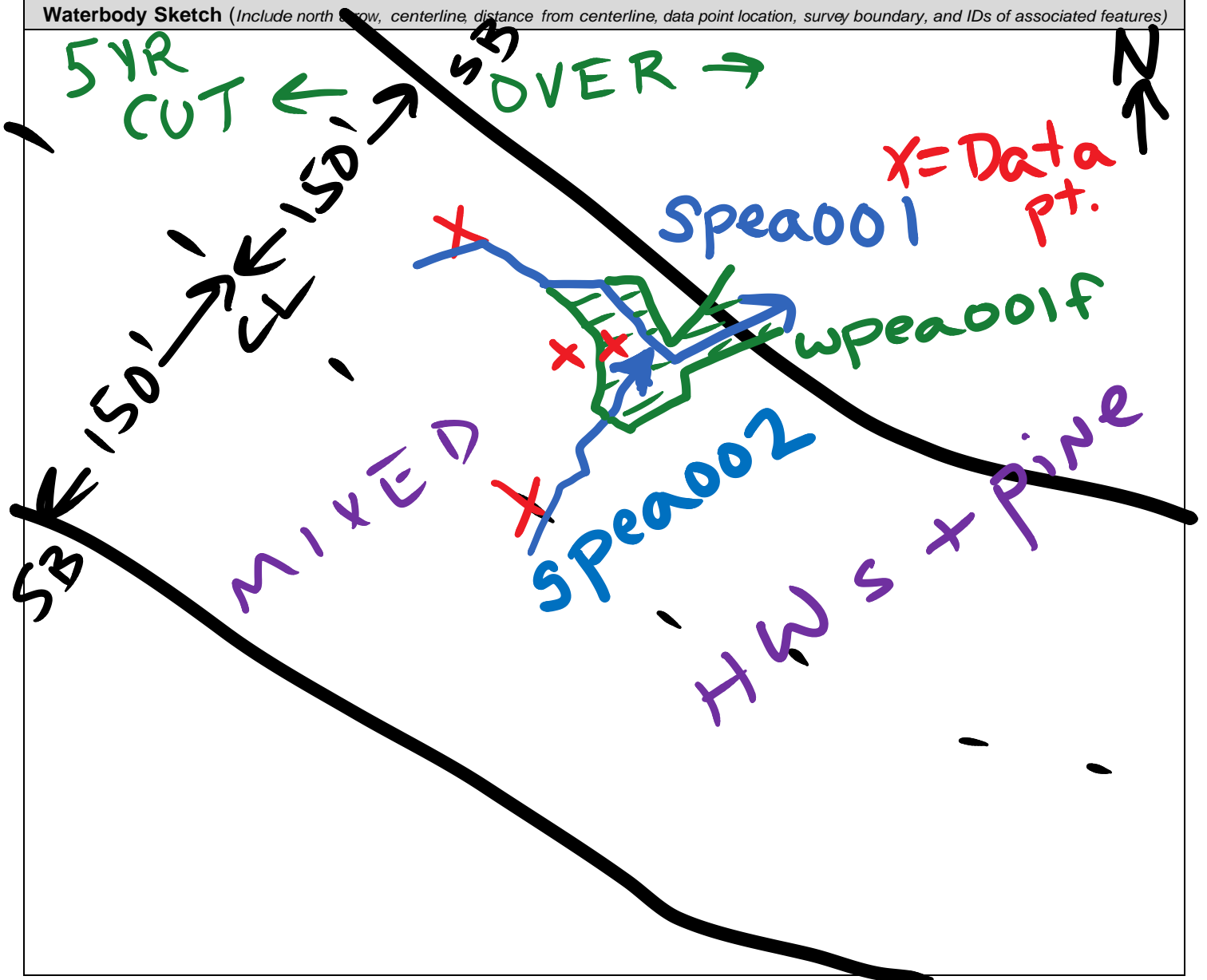



Waterbody SPEA002 facing south upstream



Waterbody SPEA002 facing north downstream



Waterbody SPEA002 facing east across

# Linear Waterbody Data Sheet

Survey Description				
Project Name: Atlantic Coast Pipeline		Waterbody Name: UNT to Little Sayers Creek		Waterbody ID: spea004
Date: 10/17/2014				
State: Virginia	County: Prince Edward	Company: NRG	Crew Member Initials: GB, LE	Photos: 3 photos
Tract Number(s): 11-053		Nearest Milepost: 221.0	Associated Wetland ID(s): wpea002	
Survey Type: <i>(check one)</i> <input checked="" type="checkbox"/> Centerline <input type="checkbox"/> Re-Route <input type="checkbox"/> Access Road <input type="checkbox"/> Other:				
Physical Attributes				
Stream Classification: <i>(check one)</i> <input type="checkbox"/> Ephemeral <input checked="" type="checkbox"/> Intermittent <input type="checkbox"/> Perennial				
Waterbody Type: <i>(check one)</i> <input type="checkbox"/> River <input checked="" type="checkbox"/> Stream <input type="checkbox"/> Ditch <input type="checkbox"/> Canal <input type="checkbox"/> Other:				
OHWM Width: 4.0 ft.		OHWM Indicator: <i>(check all that apply)</i>		
Height: 1.0 ft.		<input checked="" type="checkbox"/> Clear line on bank <input checked="" type="checkbox"/> Shelving <input type="checkbox"/> Wrested vegetation <input checked="" type="checkbox"/> Scouring <input type="checkbox"/> Water staining <input type="checkbox"/> Bent, matted, or missing vegetation <input type="checkbox"/> Wrack line <input type="checkbox"/> Litter and debris <input type="checkbox"/> Abrupt plant community change <input type="checkbox"/> Soil characteristic change		
N/A <input type="checkbox"/>				
Width of Waterbody - Top of Bank to Top of Bank: 7.0 ft.	Width of Waterbody - Toe of Slope to Toe of Slope: 3.0 ft.	Width of Waterbody - Water Edge to Water Edge: 2.5 ft.	Depth of Water: <i>(Approx.)</i> 0.30 ft.	
N/A <input type="checkbox"/>		N/A <input type="checkbox"/>		
Sinuosity: <i>(check one)</i> <input type="checkbox"/> Straight <input checked="" type="checkbox"/> Meandering		Water velocity: <i>(Approx.)</i> 0.75 fps		Bank slope Right: 60 degrees Left: 90 degrees
N/A <input type="checkbox"/>		N/A <input type="checkbox"/>		
Bank height Right: 5.0 ft. Left: 5.5 ft.				
Qualitative Attributes				
Water Appearance: <i>(check one)</i> <input type="checkbox"/> No water <input checked="" type="checkbox"/> Clear <input type="checkbox"/> Turbid <input type="checkbox"/> Sheen on surface <input type="checkbox"/> Surface scum <input type="checkbox"/> Algal mats <input type="checkbox"/> Other:				
Substrate: <i>(check all that apply)</i>				
<input type="checkbox"/> Bedrock <input type="checkbox"/> Boulder <input checked="" type="checkbox"/> Cobble <input checked="" type="checkbox"/> Gravel <input checked="" type="checkbox"/> Sand <input checked="" type="checkbox"/> Silt/ clay <input checked="" type="checkbox"/> Organic <input type="checkbox"/> Other:				
% of Substrate:      _____%      _____%      5%      20%      45%      25%      5%      _____%				
Width of Riparian Zone: ft.		Vegetative Layers: <i>(check all that apply)</i>		
N/A <input checked="" type="checkbox"/>		<input checked="" type="checkbox"/> Trees: <input checked="" type="checkbox"/> Saplings/Shrubs: <input checked="" type="checkbox"/> Herbs Avg. DBH of Dominants: <i>(approx.)</i> 10.0 in.      1.5 in.		
Dominant Bank Vegetation <i>(list)</i> : Yellow poplar, black gum, beech, Red cedar, loblolly pine, Red maple, ironwood, grape, pawpaw, wood rush, woodland sedge, Christmas fern, lady fern				
Aquatic Habitats <i>(ex: submerged or emerged aquatic vegetation, overhanging banks/roots, leaf packs, large submerged wood, riffles, deep pools)</i> : Small pools, overhanging roots and banks, leaf packs				
Aquatic Organisms Observed <i>(list)</i> : Crayfish, frogs				
T&E Species Observed <i>(list)</i> : none				
Disturbances <i>(ex: livestock access, manure in waterbody, waste discharge pipes)</i> : None apparent				
Tributary is: <i>(check one)</i> <input checked="" type="checkbox"/> Natural <input type="checkbox"/> Artificial, man-made <input type="checkbox"/> Manipulated				
Stream Quality <sup>a</sup> : <i>(check one)</i> <input type="checkbox"/> High <input checked="" type="checkbox"/> Moderate <input type="checkbox"/> Low				

Waterbody ID:  
spea004

<sup>a</sup> **High Quality:** Natural channel, natural vegetation extends at least one or two active channel widths on each side; banks stable and protected by roots; water color is clear to tea-colored; no barriers to fish movement; many fish cover types available; diverse and stable aquatic habitat; no disturbance by livestock or man.

**Moderate Quality:** Altered channel evidenced by rip-rap; natural vegetation extends 1/3-1/2 of the active channel width on each side; filtering function or riparian vegetation only moderately compromised; banks moderately unstable; water color is cloudy, submerged objects covered with greenish film; moderate odor; minor barriers to fish movement; fair aquatic habitat; minimum disturbance by livestock or man.

**Low Quality:** Channel is actively down cutting or widening; rip rap and channelization excessive; natural vegetation less than 1/3 of the active channel width on each side; lack of regeneration; filtering function severely compromised; banks unstable (eroding); water color is muddy and turbid; obvious pollutants (algal mats, surface scum, surface sheen); heavy odor; severe barriers to fish movement; little to no aquatic habitat; severe disturbance from livestock or man.

**Notes:**

Upstream continues out of corridor, downstream flows into spea003; flows through mature mixed hardwood and pine forest; saturated PFO wpea002 is a small seep that is hydrologically connected to spea003 & spea004 at the confluence of the streams.

**Waterbody Sketch** (Include north arrow, centerline, distance from centerline, data point location, survey boundary, and IDs of associated features)

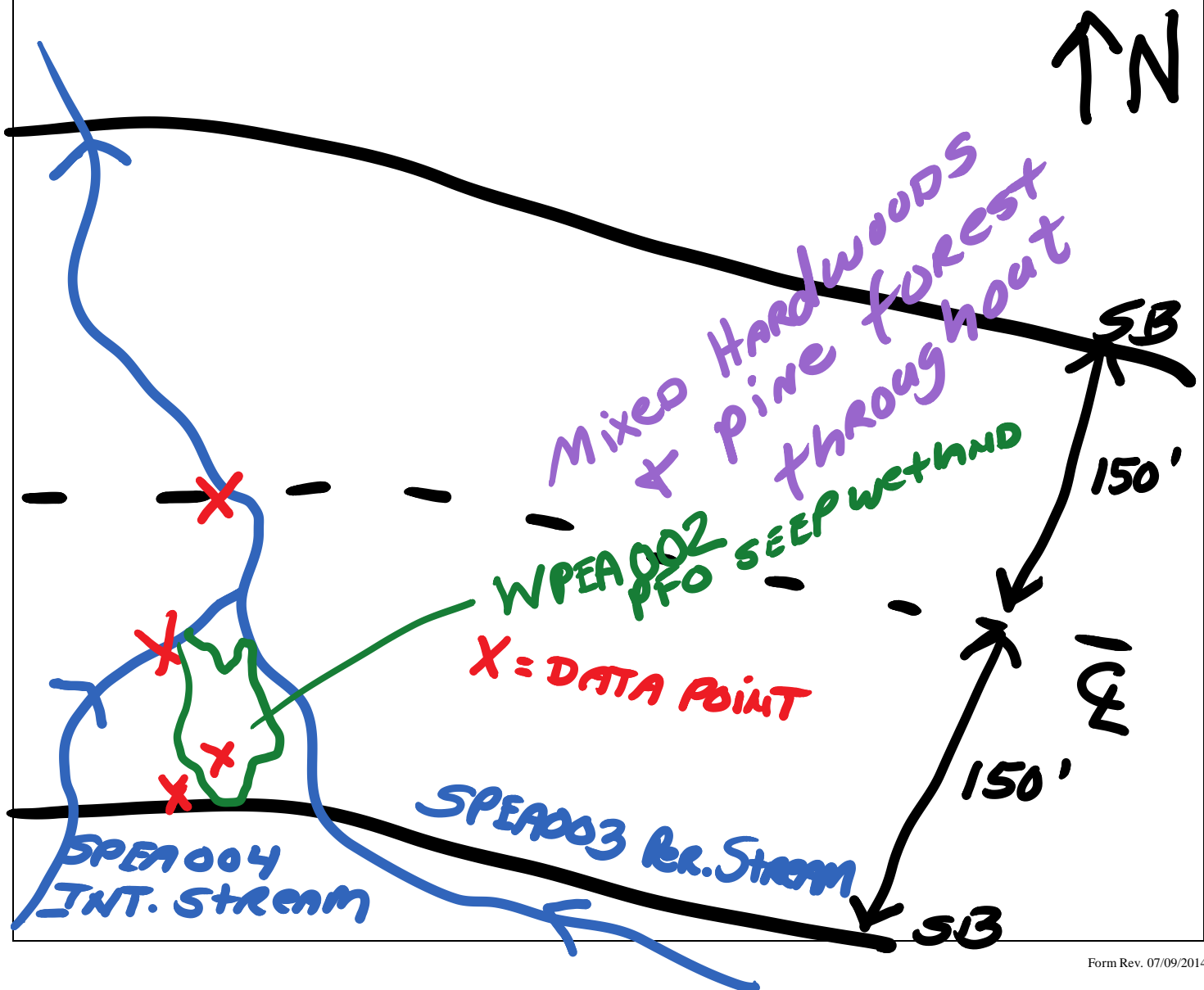



Waterbody SPEA004 facing southwest upstream



Waterbody SPEA004 facing northeast downstream



Waterbody SPEA004 facing southeast across



# Linear Waterbody Data Sheet

Survey Description				
Project Name: Atlantic Coast Pipeline		Waterbody Name: UNT to Little Sayers Creek		Waterbody ID: spea003
Date: 10/17/2014				
State: Virginia	County: Prince Edward	Company: NRG	Crew Member Initials: GB, LE	Photos: 3 photos
Tract Number(s): 11-053		Nearest Milepost: 221.0		Associated Wetland ID(s): wpea002
Survey Type: <i>(check one)</i> <input checked="" type="checkbox"/> Centerline <input type="checkbox"/> Re-Route <input type="checkbox"/> Access Road <input type="checkbox"/> Other:				
Physical Attributes				
Stream Classification: <i>(check one)</i> <input type="checkbox"/> Ephemeral <input type="checkbox"/> Intermittent <input checked="" type="checkbox"/> Perennial				
Waterbody Type: <i>(check one)</i> <input type="checkbox"/> River <input checked="" type="checkbox"/> Stream <input type="checkbox"/> Ditch <input type="checkbox"/> Canal <input type="checkbox"/> Other:				
OHWM Width: 6.0 ft.		OHWM Indicator: <i>(check all that apply)</i>		
Height: 1.75 ft.		<input checked="" type="checkbox"/> Clear line on bank <input checked="" type="checkbox"/> Shelving <input type="checkbox"/> Wrested vegetation <input checked="" type="checkbox"/> Scouring <input type="checkbox"/> Water staining		
N/A <input type="checkbox"/>		<input type="checkbox"/> Bent, matted, or missing vegetation <input checked="" type="checkbox"/> Wrack line <input type="checkbox"/> Litter and debris <input type="checkbox"/> Abrupt plant community change <input type="checkbox"/> Soil characteristic change		
Width of Waterbody - Top of Bank to Top of Bank: 12.0 ft.		Width of Waterbody - Toe of Slope to Toe of Slope: 4.0 ft.		Width of Waterbody - Water Edge to Water Edge: 5.0 ft.
N/A <input type="checkbox"/>		N/A <input type="checkbox"/>		Depth of Water: <i>(Approx.)</i> 1.0 ft.
N/A <input type="checkbox"/>		N/A <input type="checkbox"/>		N/A <input type="checkbox"/>
Sinuosity: <i>(check one)</i> <input type="checkbox"/> Straight <input checked="" type="checkbox"/> Meandering		Water velocity: <i>(Approx.)</i> 1.0 fps		Bank height: Right: 6.0 ft. Left: 3.5 ft.
N/A <input type="checkbox"/>		N/A <input type="checkbox"/>		Bank slope: Right: 80 degrees Left: 75 degrees
N/A <input type="checkbox"/>		N/A <input type="checkbox"/>		N/A <input type="checkbox"/>
Qualitative Attributes				
Water Appearance: <i>(check one)</i> <input type="checkbox"/> No water <input checked="" type="checkbox"/> Clear <input type="checkbox"/> Turbid <input type="checkbox"/> Sheen on surface <input type="checkbox"/> Surface scum <input type="checkbox"/> Algal mats <input type="checkbox"/> Other:				
Substrate: <i>(check all that apply)</i> <input type="checkbox"/> Bedrock <input type="checkbox"/> Boulder <input checked="" type="checkbox"/> Cobble <input checked="" type="checkbox"/> Gravel <input checked="" type="checkbox"/> Sand <input checked="" type="checkbox"/> Silt/ clay <input type="checkbox"/> Organic <input type="checkbox"/> Other:				
% of Substrate:      _____%      _____%      15%      10%      45%      30%      _____%      _____%				
Width of Riparian Zone: 100 ft.		Vegetative Layers: <i>(check all that apply)</i> <input checked="" type="checkbox"/> Trees: <input checked="" type="checkbox"/> Saplings/Shrubs: <input checked="" type="checkbox"/> Herbs		
N/A <input type="checkbox"/>		Avg. DBH of Dominants: <i>(approx.)</i> 10.0 in.      1.5 in.		
Dominant Bank Vegetation <i>(list)</i> : Yellow poplar, black gum, beech, Red cedar, loblolly pine, Red maple, ironwood, grape, pawpaw, wood rush, woodland sedge, Christmas fern, lady fern				
Aquatic Habitats <i>(ex: submerged or emerged aquatic vegetation, overhanging banks/roots, leaf packs, large submerged wood, riffles, deep pools)</i> : Pools, riffles, overhanging roots and banks, leaf packs, coarse woody debris				
Aquatic Organisms Observed <i>(list)</i> : Crayfish, minnows, water striders, frogs				
T&E Species Observed <i>(list)</i> : none				
Disturbances <i>(ex: livestock access, manure in waterbody, waste discharge pipes)</i> : None apparent				
Tributary is: <i>(check one)</i> <input checked="" type="checkbox"/> Natural <input type="checkbox"/> Artificial, man-made <input type="checkbox"/> Manipulated				
Stream Quality <sup>a</sup> : <i>(check one)</i> <input checked="" type="checkbox"/> High <input type="checkbox"/> Moderate <input type="checkbox"/> Low				

Waterbody ID:  
spea003

<sup>a</sup> **High Quality:** Natural channel, natural vegetation extends at least one or two active channel widths on each side; banks stable and protected by roots; water color is clear to tea-colored; no barriers to fish movement; many fish cover types available; diverse and stable aquatic habitat; no disturbance by livestock or man.

**Moderate Quality:** Altered channel evidenced by rip-rap; natural vegetation extends 1/3-1/2 of the active channel width on each side; filtering function or riparian vegetation only moderately compromised; banks moderately unstable; water color is cloudy, submerged objects covered with greenish film; moderate odor; minor barriers to fish movement; fair aquatic habitat; minimum disturbance by livestock or man.

**Low Quality:** Channel is actively down cutting or widening; rip rap and channelization excessive; natural vegetation less than 1/3 of the active channel width on each side; lack of regeneration; filtering function severely compromised; banks unstable (eroding); water color is muddy and turbid; obvious pollutants (algal mats, surface scum, surface sheen); heavy odor; severe barriers to fish movement; little to no aquatic habitat; severe disturbance from livestock or man.

**Notes:**

Continues out of corridor, flows through mature mixed hardwood and pine forest, spea004 is a tributary; saturated PFO wpea002 is a small seep that is hydrologically connected to spea003 & spea004 at the confluence of the streams.

**Waterbody Sketch** (Include north arrow, centerline, distance from centerline, data point location, survey boundary, and IDs of associated features)

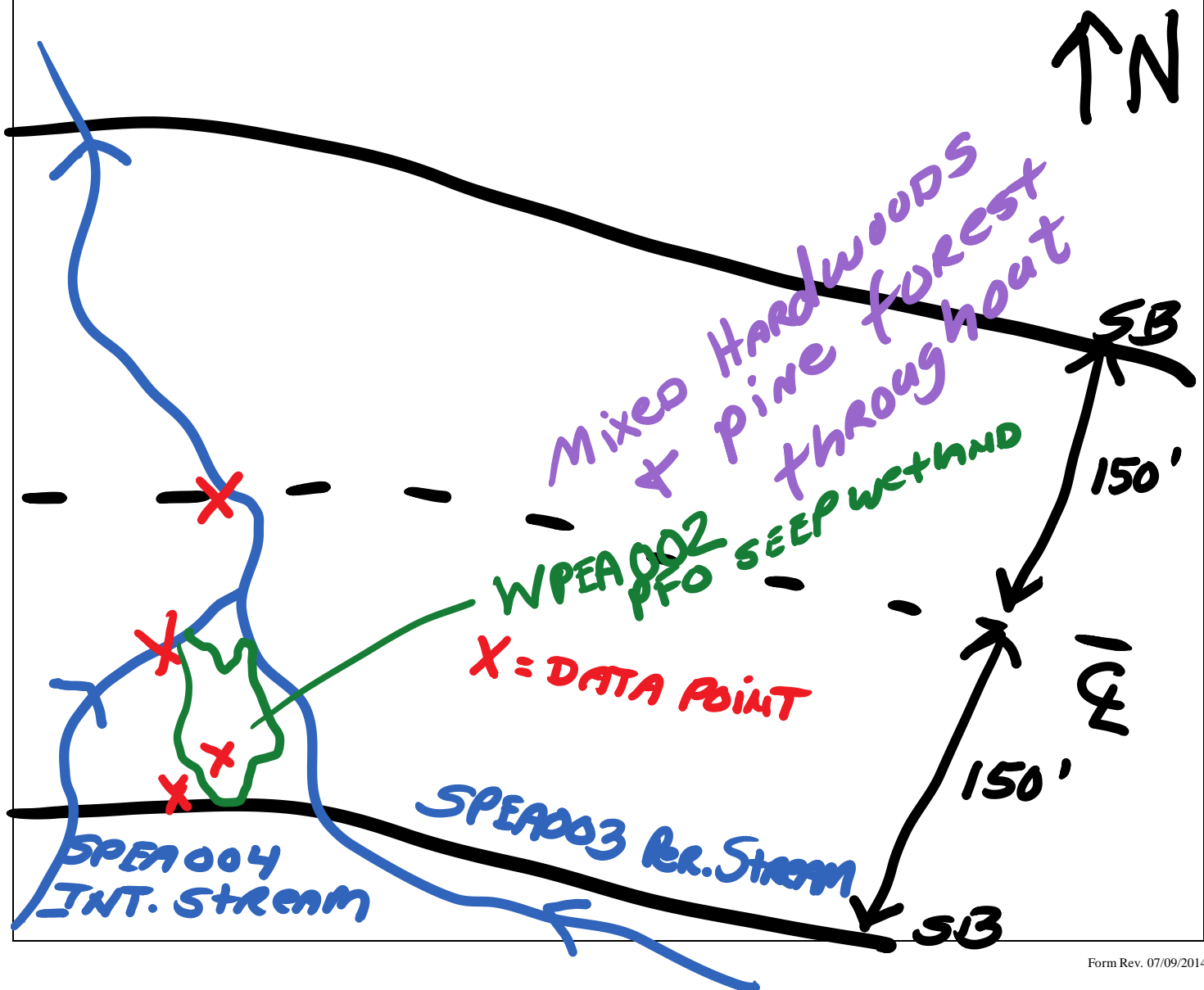



Waterbody SPEA003 facing southeast upstream



Waterbody SPEA003 facing northwest downstream



Waterbody SPEA003 facing southwest across

# Linear Waterbody Data Sheet

Survey Description				
Project Name: Atlantic Coast Pipeline		Waterbody Name: UNT to Little Sayers Creek		Waterbody ID: spea005
Date: 10/17/2014				
State: Virginia	County: Prince Edward	Company: NRG	Crew Member Initials: GB, LE	Photos: 3 photos
Tract Number(s): 11-054; 11-054.01		Nearest Milepost: 221.25	Associated Wetland ID(s): wpea003	
Survey Type: <i>(check one)</i> <input checked="" type="checkbox"/> Centerline <input type="checkbox"/> Re-Route <input type="checkbox"/> Access Road <input type="checkbox"/> Other:				
Physical Attributes				
Stream Classification: <i>(check one)</i> <input type="checkbox"/> Ephemeral <input checked="" type="checkbox"/> Intermittent <input type="checkbox"/> Perennial				
Waterbody Type: <i>(check one)</i> <input type="checkbox"/> River <input checked="" type="checkbox"/> Stream <input type="checkbox"/> Ditch <input type="checkbox"/> Canal <input type="checkbox"/> Other:				
OHWM Width: 2.0 ft.		OHWM Indicator: <i>(check all that apply)</i>		
Height: 0.5 ft.		<input type="checkbox"/> Clear line on bank <input type="checkbox"/> Shelving <input type="checkbox"/> Wrested vegetation <input checked="" type="checkbox"/> Scouring <input type="checkbox"/> Water staining <input type="checkbox"/> Bent, matted, or missing vegetation <input type="checkbox"/> Wrack line <input checked="" type="checkbox"/> Litter and debris <input type="checkbox"/> Abrupt plant community change <input type="checkbox"/> Soil characteristic change		
N/A <input type="checkbox"/>				
Width of Waterbody - Top of Bank to Top of Bank: 3.5 ft.	Width of Waterbody - Toe of Slope to Toe of Slope: 1.0 ft.	Width of Waterbody - Water Edge to Water Edge: 1.5 ft.	Depth of Water: <i>(Approx.)</i> 0.20 ft.	
N/A <input type="checkbox"/>		N/A <input type="checkbox"/>		
Sinuosity: <i>(check one)</i> <input type="checkbox"/> Straight <input checked="" type="checkbox"/> Meandering	Water velocity: <i>(Approx.)</i> 0.50 fps N/A <input type="checkbox"/>	Bank height Right: 4.0 ft. Left: 4.0 ft.	Bank slope Right: 80 degrees Left: 90 degrees	
Qualitative Attributes				
Water Appearance: <i>(check one)</i> <input type="checkbox"/> No water <input checked="" type="checkbox"/> Clear <input type="checkbox"/> Turbid <input type="checkbox"/> Sheen on surface <input type="checkbox"/> Surface scum <input type="checkbox"/> Algal mats <input type="checkbox"/> Other:				
Substrate: <i>(check all that apply)</i> % of Substrate:      _____%      _____%      _____%      _____%      35%      60%      5%      _____%				
Width of Riparian Zone: _____ ft. N/A <input checked="" type="checkbox"/>	Vegetative Layers: <i>(check all that apply)</i> <input checked="" type="checkbox"/> Trees: <input checked="" type="checkbox"/> Saplings/Shrubs: <input checked="" type="checkbox"/> Herbs Avg. DBH of Dominants: <i>(approx.)</i> 9.0 in.      1.75 in.			
Dominant Bank Vegetation <i>(list)</i> : Sweetgum, red maple, black gum, yellow poplar, sourwood, dogwood, juniper, greenbrier, Christmas fern, wood oats				
Aquatic Habitats (ex: submerged or emerged aquatic vegetation, overhanging banks/roots, leaf packs, large submerged wood, riffles, deep pools): Small pools, leaf packs				
Aquatic Organisms Observed <i>(list)</i> : none				
T&E Species Observed <i>(list)</i> : none				
Disturbances (ex: livestock access, manure in waterbody, waste discharge pipes): Recent clear cut, high sediment load and down cutting				
Tributary is: <i>(check one)</i> <input checked="" type="checkbox"/> Natural <input type="checkbox"/> Artificial, man-made <input type="checkbox"/> Manipulated				
Stream Quality <sup>a</sup> : <i>(check one)</i> <input type="checkbox"/> High <input type="checkbox"/> Moderate <input checked="" type="checkbox"/> Low				

Waterbody ID:  
spea005

<sup>a</sup> **High Quality:** Natural channel, natural vegetation extends at least one or two active channel widths on each side; banks stable and protected by roots; water color is clear to tea-colored; no barriers to fish movement; many fish cover types available; diverse and stable aquatic habitat; no disturbance by livestock or man.

**Moderate Quality:** Altered channel evidenced by rip-rap; natural vegetation extends 1/3-1/2 of the active channel width on each side; filtering function or riparian vegetation only moderately compromised; banks moderately unstable; water color is cloudy, submerged objects covered with greenish film; moderate odor; minor barriers to fish movement; fair aquatic habitat; minimum disturbance by livestock or man.

**Low Quality:** Channel is actively down cutting or widening; rip rap and channelization excessive; natural vegetation less than 1/3 of the active channel width on each side; lack of regeneration; filtering function severely compromised; banks unstable (eroding); water color is muddy and turbid; obvious pollutants (algal mats, surface scum, surface sheen); heavy odor; severe barriers to fish movement; little to no aquatic habitat; severe disturbance from livestock or man.

**Notes:**

Clear cut in last year to southeast, mixed hardwoods and pines to the northwest; downstream continues out of corridor where it flows into spea003; upstream is outflow from wpea003.

**Waterbody Sketch** (Include north arrow, centerline, distance from centerline, data point location, survey boundary, and IDs of associated features)

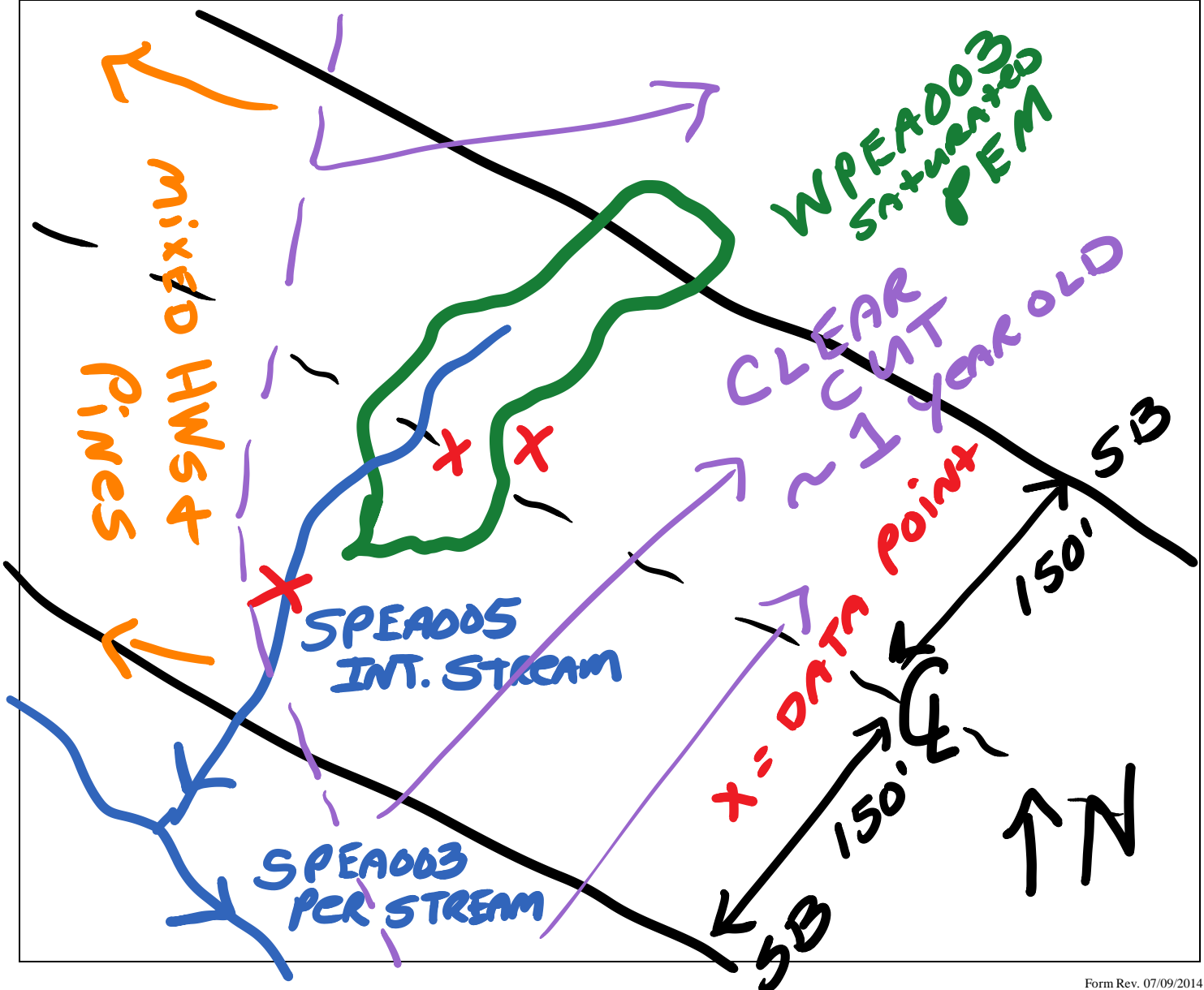



Waterbody SPEA005 facing northeast upstream



Waterbody SPEA005 facing southwest downstream



Waterbody SPEA005 facing southeast across



# Linear Waterbody Data Sheet

Survey Description				
Project Name: Atlantic Coast Pipeline		Waterbody Name: UNT to Little Sayers Creek		Waterbody ID: SPEC001
State: Virginia		County: Prince Edward	Company: NRG	Date: 1/7/2015
Tract Number(s): 11-064		Nearest Milepost: 222.3		Photos: SPEC001_001-003
Associated Wetland ID(s): WPEC001				
Survey Type: <i>(check one)</i> <input checked="" type="checkbox"/> Centerline <input type="checkbox"/> Re-Route <input type="checkbox"/> Access Road <input type="checkbox"/> Other:				
Physical Attributes				
Stream Classification: <i>(check one)</i> <input type="checkbox"/> Ephemeral <input checked="" type="checkbox"/> Intermittent <input type="checkbox"/> Perennial				
Waterbody Type: <i>(check one)</i> <input type="checkbox"/> River <input checked="" type="checkbox"/> Stream <input type="checkbox"/> Ditch <input type="checkbox"/> Canal <input type="checkbox"/> Other:				
OHWM Width: <u>  2  </u> ft.		OHWM Indicator: <i>(check all that apply)</i> <input checked="" type="checkbox"/> Clear line on bank <input type="checkbox"/> Shelving <input type="checkbox"/> Wrested vegetation <input type="checkbox"/> Scouring <input type="checkbox"/> Water staining		
OHWM Height: <u>  0.5  </u> ft.		<input checked="" type="checkbox"/> Bent, matted, or missing vegetation <input type="checkbox"/> Wrack line <input type="checkbox"/> Litter and debris <input type="checkbox"/> Abrupt plant community change <input type="checkbox"/> Soil characteristic change		
N/A <input type="checkbox"/>				
Width of Waterbody - Top of Bank to Top of Bank: <u>  3  </u> ft.		Width of Waterbody - Toe of Slope to Toe of Slope: <u>  1  </u> ft.		Depth of Water: <i>(Approx.)</i> <u>  0.3  </u> ft.
Width of Waterbody - Water Edge to Water Edge: <u>  1.5  </u> ft.		N/A <input type="checkbox"/>		N/A <input type="checkbox"/>
Sinuosity: <i>(check one)</i> <input type="checkbox"/> Straight <input checked="" type="checkbox"/> Meandering		Water velocity: <i>(Approx.)</i> <u>  2  </u> fps		Bank slope Right: <u>  80  </u> degrees Left: <u>  80  </u> degrees
N/A <input type="checkbox"/>		N/A <input type="checkbox"/>		
Bank height Right: <u>  1  </u> ft. Left: <u>  1  </u> ft.				
Qualitative Attributes				
Water Appearance: <i>(check one)</i> <input type="checkbox"/> No water <input checked="" type="checkbox"/> Clear <input type="checkbox"/> Turbid <input type="checkbox"/> Sheen on surface <input type="checkbox"/> Surface scum <input type="checkbox"/> Algal mats <input type="checkbox"/> Other:				
Substrate: <i>(check all that apply)</i> <input type="checkbox"/> Bedrock <input type="checkbox"/> Boulder <input type="checkbox"/> Cobble <input type="checkbox"/> Gravel <input checked="" type="checkbox"/> Sand <input checked="" type="checkbox"/> Silt/ clay <input type="checkbox"/> Organic <input type="checkbox"/> Other:				
% of Substrate:      _____%      _____%      _____%      _____% <u>  80  </u> % <u>  20  </u> %      _____%      _____%				
Width of Riparian Zone: <u>      </u> ft.		Vegetative Layers: <i>(check all that apply)</i> <input checked="" type="checkbox"/> Trees: <input checked="" type="checkbox"/> Saplings/Shrubs: <input checked="" type="checkbox"/> Herbs		
N/A <input checked="" type="checkbox"/>		Avg. DBH of Dominants: <i>(approx.)</i> <u>  10  </u> in. <u>  1  </u> in.		
Dominant Bank Vegetation <i>(list)</i> : White oak, scarlet oak, southern red cedar, American hornbeam, blackberry, Christmas fern, juncus effusus, skunk cabbage				
Aquatic Habitats (ex: submerged or emerged aquatic vegetation, overhanging banks/roots, leaf packs, large submerged wood, riffles, deep pools): Leaf packs, riffles and pools				
Aquatic Organisms Observed <i>(list)</i> : None				
T&E Species Observed <i>(list)</i> : None				
Disturbances (ex: livestock access, manure in waterbody, waste discharge pipes): None				
Tributary is: <i>(check one)</i> <input checked="" type="checkbox"/> Natural <input type="checkbox"/> Artificial, man-made <input type="checkbox"/> Manipulated				
Stream Quality <sup>a</sup> : <i>(check one)</i> <input type="checkbox"/> High <input checked="" type="checkbox"/> Moderate <input type="checkbox"/> Low				

Waterbody ID:

SPEC001

<sup>a</sup> **High Quality:** Natural channel, natural vegetation extends at least one or two active channel widths on each side; banks stable and protected by roots; water color is clear to tea-colored; no barriers to fish movement; many fish cover types available; diverse and stable aquatic habitat; no disturbance by livestock or man.

**Moderate Quality:** Altered channel evidenced by rip-rap; natural vegetation extends 1/3-1/2 of the active channel width on each side; filtering function or riparian vegetation only moderately compromised; banks moderately unstable; water color is cloudy, submerged objects covered with greenish film; moderate odor; minor barriers to fish movement; fair aquatic habitat; minimum disturbance by livestock or man.

**Low Quality:** Channel is actively down cutting or widening; rip rap and channelization excessive; natural vegetation less than 1/3 of the active channel width on each side; lack of regeneration; filtering function severely compromised; banks unstable (eroding); water color is muddy and turbid; obvious pollutants (algal mats, surface scum, surface sheen); heavy odor; severe barriers to fish movement; little to no aquatic habitat; severe disturbance from livestock or man.

**Notes:**

Stream flows underground in a few places within the corridor. Stream is underground where it crosses centerline.

**Waterbody Sketch** (Include north arrow, centerline, distance from centerline, data point location, survey boundary, and IDs of associated features)

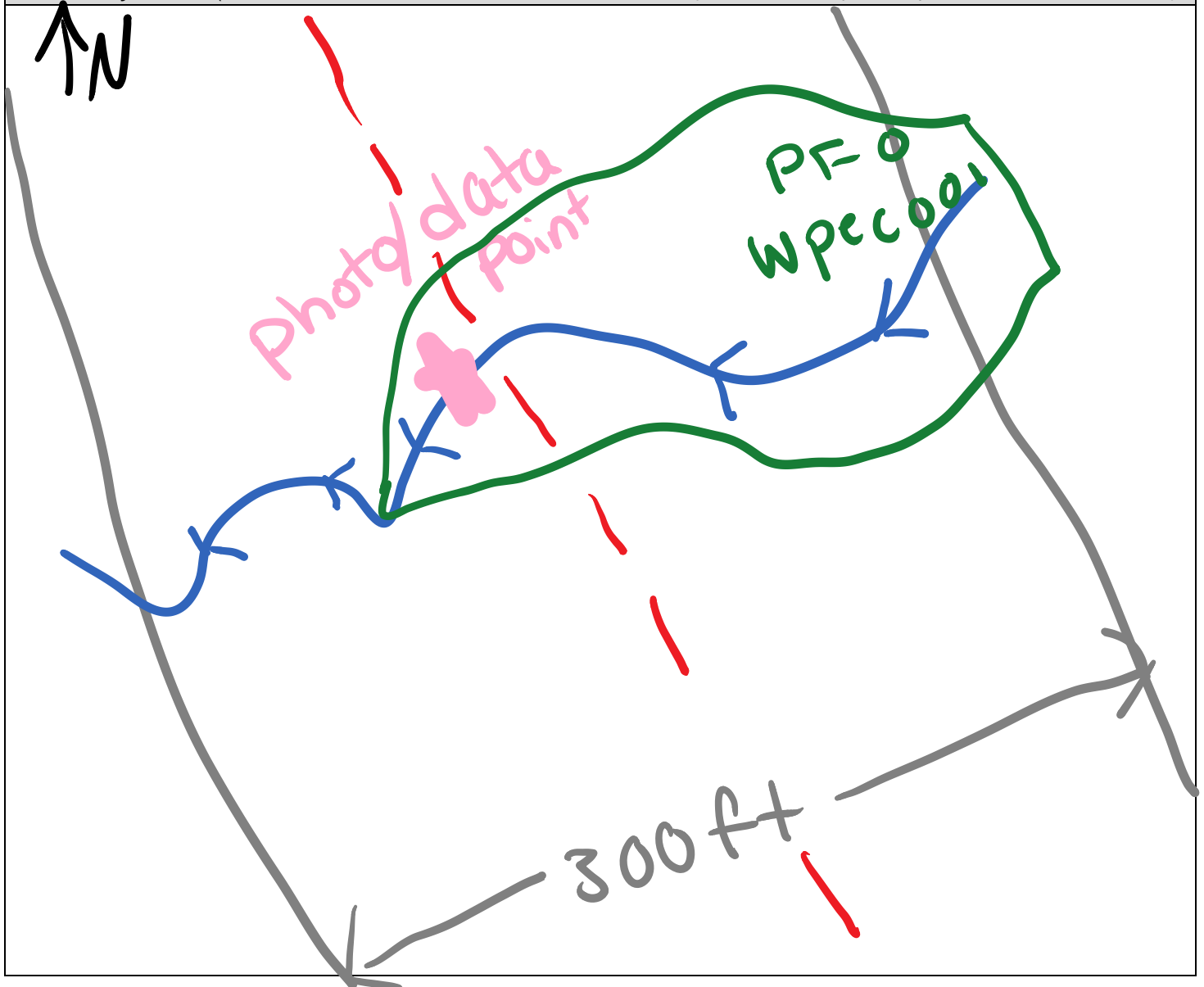



Waterbody SPEC001 facing upstream



Waterbody SPEC001 facing downstream



Waterbody SPEC001 facing across

# Linear Waterbody Data Sheet

Survey Description				
Project Name: Atlantic Coast Pipeline		Waterbody Name: UNT to Little Sayers Creek		Waterbody ID: spea007
Date: 10/20/2014				
State: Virginia	County: Prince Edward	Company: NRG	Crew Member Initials: GB, TP	Photos: 3 photos
Tract Number(s): 11-069		Nearest Milepost: 222.65	Associated Wetland ID(s): wpea006	
Survey Type: <i>(check one)</i> <input checked="" type="checkbox"/> Centerline <input type="checkbox"/> Re-Route <input type="checkbox"/> Access Road <input type="checkbox"/> Other:				
Physical Attributes				
Stream Classification: <i>(check one)</i> <input type="checkbox"/> Ephemeral <input checked="" type="checkbox"/> Intermittent <input type="checkbox"/> Perennial				
Waterbody Type: <i>(check one)</i> <input type="checkbox"/> River <input checked="" type="checkbox"/> Stream <input type="checkbox"/> Ditch <input type="checkbox"/> Canal <input type="checkbox"/> Other:				
OHWM Width: 2.0 ft.		OHWM Indicator: <i>(check all that apply)</i> <input checked="" type="checkbox"/> Clear line on bank <input type="checkbox"/> Shelving <input type="checkbox"/> Wrested vegetation <input checked="" type="checkbox"/> Scouring <input type="checkbox"/> Water staining		
OHWM Height: 0.5 ft.		<input type="checkbox"/> Bent, matted, or missing vegetation <input type="checkbox"/> Wrack line <input checked="" type="checkbox"/> Litter and debris <input type="checkbox"/> Abrupt plant community change <input type="checkbox"/> Soil characteristic change		
N/A <input type="checkbox"/>				
Width of Waterbody - Top of Bank to Top of Bank: 3.0 ft.	Width of Waterbody - Toe of Slope to Toe of Slope: 2.5 ft.	Width of Waterbody - Water Edge to Water Edge: 1.5 ft.	Depth of Water: <i>(Approx.)</i> 0.20 ft.	
N/A <input type="checkbox"/>		N/A <input type="checkbox"/>		
Sinuosity: <i>(check one)</i> <input type="checkbox"/> Straight <input checked="" type="checkbox"/> Meandering		Water velocity: <i>(Approx.)</i> 0.1 fps		Bank slope Right: 80 degrees Left: 80 degrees
N/A <input type="checkbox"/>		N/A <input type="checkbox"/>		
Qualitative Attributes				
Water Appearance: <i>(check one)</i> <input type="checkbox"/> No water <input checked="" type="checkbox"/> Clear <input type="checkbox"/> Turbid <input type="checkbox"/> Sheen on surface <input type="checkbox"/> Surface scum <input type="checkbox"/> Algal mats <input type="checkbox"/> Other:				
Substrate: <i>(check all that apply)</i> <input type="checkbox"/> Bedrock <input type="checkbox"/> Boulder <input type="checkbox"/> Cobble <input type="checkbox"/> Gravel <input checked="" type="checkbox"/> Sand <input checked="" type="checkbox"/> Silt/ clay <input checked="" type="checkbox"/> Organic <input type="checkbox"/> Other:				
% of Substrate:      ___%      ___%      ___%      ___%      65%      25%      10%      ___%				
Width of Riparian Zone: _____ ft.		Vegetative Layers: <i>(check all that apply)</i> <input checked="" type="checkbox"/> Trees: <input checked="" type="checkbox"/> Saplings/Shrubs: <input checked="" type="checkbox"/> Herbs		
N/A <input checked="" type="checkbox"/>		Avg. DBH of Dominants: <i>(approx.)</i> 14.0 in.      0.5 in.		
Dominant Bank Vegetation <i>(list)</i> : Yellow poplar, red maple, opossum haw, white oak, Japanese honeysuckle, netted chain fern, Christmas fern, greenbrier				
Aquatic Habitats (ex: submerged or emerged aquatic vegetation, overhanging banks/roots, leaf packs, large submerged wood, riffles, deep pools): Small pools, leaf packs				
Aquatic Organisms Observed <i>(list)</i> : none				
T&E Species Observed <i>(list)</i> : none				
Disturbances (ex: livestock access, manure in waterbody, waste discharge pipes): none				
Tributary is: <i>(check one)</i> <input checked="" type="checkbox"/> Natural <input type="checkbox"/> Artificial, man-made <input type="checkbox"/> Manipulated				
Stream Quality <sup>a</sup> : <i>(check one)</i> <input type="checkbox"/> High <input checked="" type="checkbox"/> Moderate <input type="checkbox"/> Low				

Waterbody ID:  
spea007

<sup>a</sup> **High Quality:** Natural channel, natural vegetation extends at least one or two active channel widths on each side; banks stable and protected by roots; water color is clear to tea-colored; no barriers to fish movement; many fish cover types available; diverse and stable aquatic habitat; no disturbance by livestock or man.

**Moderate Quality:** Altered channel evidenced by rip-rap; natural vegetation extends 1/3-1/2 of the active channel width on each side; filtering function or riparian vegetation only moderately compromised; banks moderately unstable; water color is cloudy, submerged objects covered with greenish film; moderate odor; minor barriers to fish movement; fair aquatic habitat; minimum disturbance by livestock or man.

**Low Quality:** Channel is actively down cutting or widening; rip rap and channelization excessive; natural vegetation less than 1/3 of the active channel width on each side; lack of regeneration; filtering function severely compromised; banks unstable (eroding); water color is muddy and turbid; obvious pollutants (algal mats, surface scum, surface sheen); heavy odor; severe barriers to fish movement; little to no aquatic habitat; severe disturbance from livestock or man.

**Notes:**

Stream begins at head cut near the northern edge of corridor, downstream continues out of corridor, flows through PFO wetland wpea006; forested draw between hayfields.

**Waterbody Sketch** (Include north arrow, centerline, distance from centerline, data point location, survey boundary, and IDs of associated features)

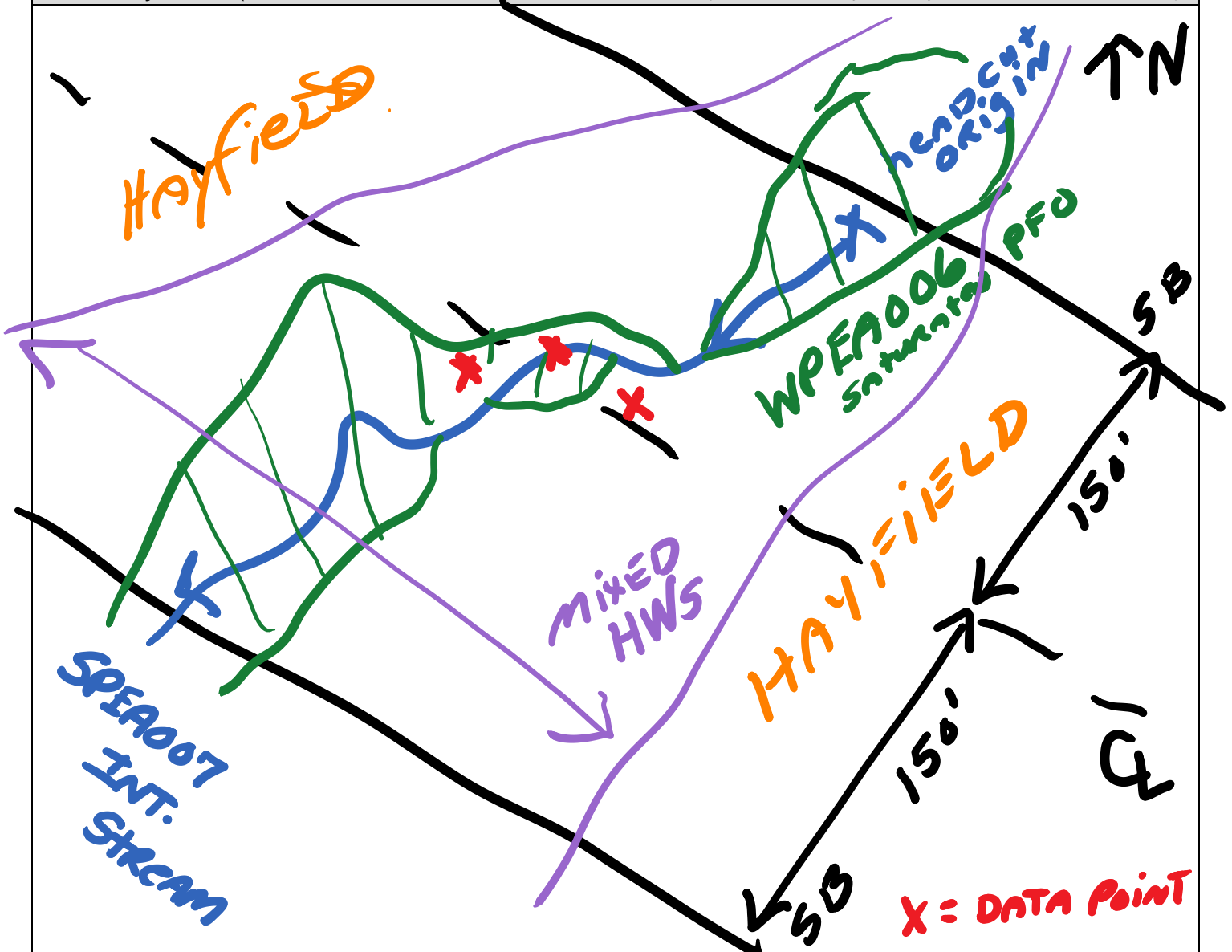



SPEA007 facing east upstream



SPEA007 facing southwest downstream



SPEA007 facing south across